

#OURPASSIONISYOURS

Eleveight 

#ELEVEIGHT2020

PRODUCT / BOOK

CONTENT

KITES

RSeries	Freeride / Cross Over	08
FSeries	Freestyle / Freeride	14
WSeries	Wave / Freeride	21
OSeries	Foil / Light wind	26
PSeries	Progression / Freeride	36
TRSeries	Trainer / Beginner	44

BACKPACK

46

KITE FINDER

48

BAR

CS Vary Bar	Control series	50
-------------	----------------	----

TWINTIPS

IGNITION	Progression Freeride	58
PROCESS	Performance Freeride	64
MASTER	Freestyle / Freeride	70
MASTER+	Freestyle / Freeride	76
COMMANDER	Performance Freestyle	82

TWINTIP FINDER

88

SURFBOARDS

CURL	Performance Surfboard	92
ESCAPE	Freestyle Surfboard	98
CURL PRO	Performance Surfboard	106
ESCAPE PRO	Freestyle Surfboard	110

FOIL

HCS	Performance Freeride	118
HCS+	Progression Freeride	124
CARVAIR	Freeride Board	130

ACCESSORIES

138

E/8 TRUSTED QUALITY

150

PLUS 8 EXTENDED WARRANTY

153

THE BRAND

154

Rider: Team Eleveight
Picture: Samuel Flotat



“DEVELOPMENT NEVER STOPS - ELEVEIGHT 2020”

The last year of operation marked our first complete development and sales cycle. It was a year filled with more excitement, innovation, and success than we could have hoped for. We were left more eager than ever to develop an outstanding 2020 product lineup.

Our new product range reflects Eleveight's core beliefs in high-performance products with superior build quality. The foundation of the new products was the open and honest communication with all of you, our partners.

Our vision to build and establish Eleveight as a leading brand has been our driving force for the last three years. We are very proud of how far we have come, and know that it would not have been possible without the support of the right people. We feel honored to work with partners that share the same values and help us push the limits of product development.

The Eleveight 2020 product range expanded in every segment and became more diverse than ever before. We now offer products for each riding style to satisfy the needs of any customer group. The development process was very dynamic and combines the experience and passion of the whole team. We are beyond excited to present Eleveight 2020 to you.

Team Eleveight





/ DESIGN Vision

The RSeries with its streamlined Delta-Hybrid design is the go-to kite for riders who want to cover all riding styles with only one style of wing. It is greatly versatile, covers a huge wind range and is ultra accessible. Riders will instantly score when testing or riding this kite. Hence it is also our kite with the highest demand. We stayed true to the RS' proven design while introducing a number of improvements, such as our new five-point bridle system with additional trim option, an increased angle-of-attack, more sweep in the tips, renewed bridle deflectors, revised trailing edge load diffusers, and the latest XT (Extreme Tenacity) leading edge and strut material made in Japan. Get hooked on the RS and score every time.

/ PERFORMANCE Features

- Three strut Delta-Hybrid design
- Most versatile high-performance freeride kite
- Medium to high aspect ratio for big airs and long hang time
- Covers huge wind range and easily travels upwind
- Fast and smooth turning characteristics
- Ultra stable, perfect to tackle any spot and ride in any condition
- New bridle system with added trim option for customized performance
- Superior materials like X4 canopy and XT cloth made by Techno Force™

/ DESIGNER Quote

The RS is a high-performance freeride kite with a huge sweet spot over an impressive wind range. It is very well balanced and works for all riding styles.

Peter Stiewe

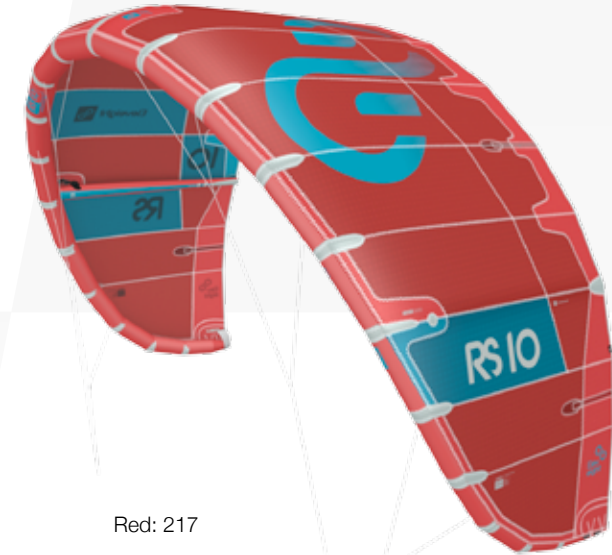

Red: 217



Yellow: 219

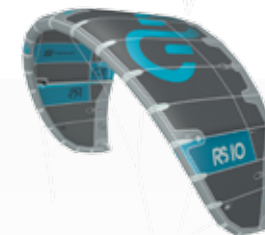

Grey: 212



Green: 216



/ RIDING Style

Freeride	●	●	●	●	●	●	●	●
Surf	●	●	●	●	●	●	●	●
Progression	●	●	●	●	●	●	●	●
Big Air / Old School	●	●	●	●	●	●	●	●
Light Wind Foil	●	●	●	●	●	●	●	●

/ WIND Range

Size / Knots 6 8 10 12 14 16 18 20 22 24 26 28 30 32 34 36 38

05 m																●	●	●	●	●	●	●	●	●	●	●	
06 m																●	●	●	●	●	●	●	●	●	●	●	●
07 m																●	●	●	●	●	●	●	●	●	●	●	●
08 m																●	●	●	●	●	●	●	●	●	●	●	●
09 m																●	●	●	●	●	●	●	●	●	●	●	●
10 m																●	●	●	●	●	●	●	●	●	●	●	●
12 m																●	●	●	●	●	●	●	●	●	●	●	●
14 m																●	●	●	●	●	●	●	●	●	●	●	●
17 m																●	●	●	●	●	●	●	●	●	●	●	●

Based on average rider weight of 75kg/165 lbs

Beaufort	2	3	4	5	6	7	8
Description	Light breeze	Gentle breeze	Moderate breeze	Fresh breeze	Strong breeze	High wind, moderate	Strong wind

/ CHANGES for 2020

- Increased angle-of-attack for enhanced power and grunt
- More sweep in the wing tips for better upwind and low end performance
- Shorter bridles for higher responsiveness and tangle-prevention
- New five-point bridle system for increased stability and linear bar feel
- Additional trim option in the front bridles allows customization of turning behavior
- Redefined trailing edge load diffuser reduces flutter and improves durability
- Thinner battens for less weight
- New load dynamic super seam to increase durability and avoid seam damage
- New Extreme Tenacity LE and strut material by Techno Force™
- New bridle deflector to cover the LE closing seam

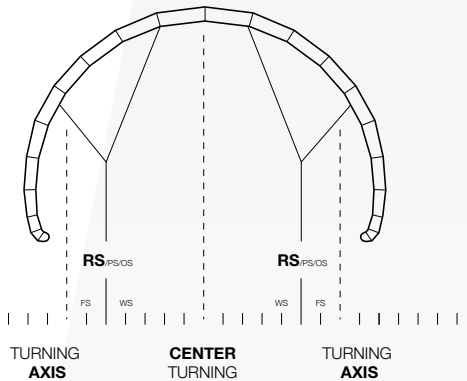

TURNING CHARACTERISTIC

- Fast turn
- Wingtip to pivot turner
- Grunty turn

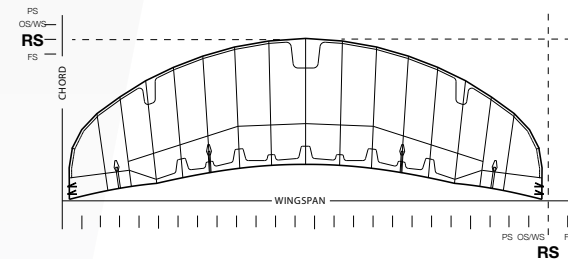

ASPECT RATIO

- Medium to high AR
- Great upwind performance
- Massive windrange

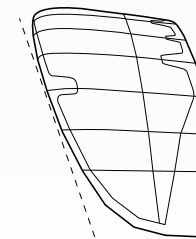

SWEEP

- Medium sweep
- Grunty power
- Long hangtime

FS

FREESTYLE
FREERIDE
SERIES



Rider: David Tonijuan Colomer
Picture: Samuel Cardenas

FSFREESTYLE
FREERIDE
SERIES

TECHNO FORCE™ X4 XT

**SIZES**

06 / 07 / 08 / 09 / 10 / 12 / 14 / 16

/ DESIGN Vision

Our high-performance FSeries kite is tailored to suit the needs of advanced freestyle and big air riders. Its Open-C design comes with all the advantages of a true C-kite such as direct control, line slack and a wide angle-of-attack for powerful loops. The kite stands out with an improved lift, stability and is accessible to handle. The low to medium swept wing tips provide extra power, which, in combination with the kite's high aspect ratio and ultra-responsive turning, results in staggering boosts. Among other changes, for the FSeries' third generation we upgraded the leading edge and strut material to the high-end XT cloth made by Techno Force™ and introduce an increased angle-of-attack as well as a higher aspect ratio and thinner struts. Our new five-point bridle system increases stability and reduces kite twist while an additional trim option allows customization of the turning behavior. The FS is an all-star power machine that tears down limits.

/ PERFORMANCE Features

- Five strut Open-C design
- High-performance kite to excel in freestyle and big air
- High aspect ratio for explosive lift
- Medium to low sweep provides power and grunt
- Plenty of line slack simplifies freestyle tricks
- Good upwind performance and great stability
- New bridle system with added trim option for customized performance
- Superior materials like X4 canopy and XT cloth made by Techno Force™

/ DESIGNER Quote

The FS is a true performance powerhouse made to go big. It combines leading materials, experienced craftsmanship, and cutting edge design.

Peter Stiewe



Grey: 112



Red: 117



Turquoise: 113



/ RIDING Style

Freeride	●	●	●	●	●	
Big Air / Megaloop	●	●	●	●	●	●
Freestyle / Wakestyle	●	●	●	●	●	●
Surf	●	●	●	●		
Light Wind Race	●	●	●	●		

/ WIND Range

Size / Knots 6 8 10 12 14 16 18 20 22 24 26 28 30 32 34 36 38

06 m	8	10	12	14	16	18	20	22	24	26	28	30	32	34	36	38
									●	●	●	●	●	●	●	●
									●	●	●	●	●	●	●	●
						●	●	●	●	●	●	●	●	●	●	●
						●	●	●	●	●	●	●	●	●	●	●
						●	●	●	●	●	●	●	●	●	●	●
						●	●	●	●	●	●	●	●	●	●	●
						●	●	●	●	●	●	●	●	●	●	●

Based on average rider weight of 75kg/165 lbs

Beaufort	2	3	4	5	6	7	8
Description	Light breeze	Gentle breeze	Moderate breeze	Fresh breeze	Strong breeze	High wind, moderate	Strong wind

/ CHANGES for 2020

- Increased aspect ratio for explosive lift
- Increased angle-of-attack for enhanced power and grunt
- Thinner struts for improved aerodynamics
- New five-point bridle system for increased stability and linear bar feel
- Additional trim option in the front bridles allows customization of turning behavior
- Redefined trailing edge load diffuser reduces flutter and improves durability
- Thinner battens for less weight
- New load dynamic super seam with added layers of cloth for lasting durability & seam protection
- New Extreme Tenacity LE and strut material by Techno Force™
- New bridle deflector to cover the LE closing seam

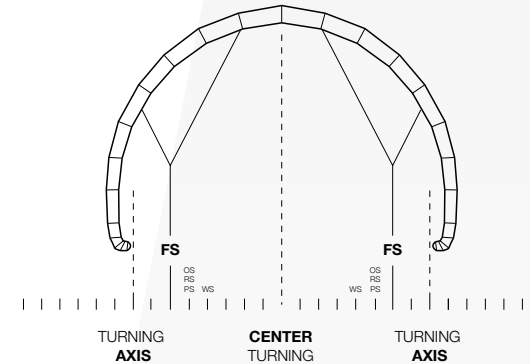

TURNING CHARACTERISTIC

- High velocity turn
- Wingtip turner
- Powerful turn

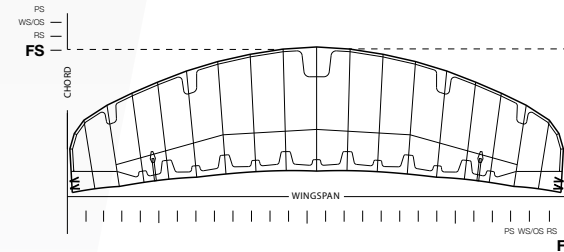

ASPECT RATIO

- High AR
- Good upwind performance
- Efficient high lift / drag ratio

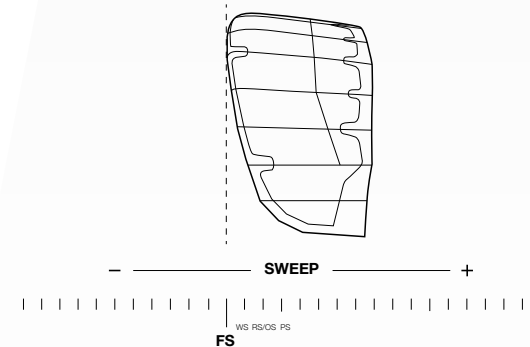

SWEEP

- Medium to low sweep
- Explosive power
- Vertical lift





/ DESIGN *Vision*

'Surf' is the essence of our WSeries kite's origin. This is the wing Eleveight CEO and designer Peter Stiewe rides when slicing through the faces of Portuguese slabs, dropping into South African wedges or hitting the lips of Brazilian walls. It combines pivotal turning with extra smooth power generation and unmatched downwind drift - its performance was proven in maxed out Nazaré but also transfers to small wind swell at everyday spots. The third generation is equipped with our new trimmable five-point bridle system and comes with a flattened arc that improves the low end strength while optimizing the power generation in pivotal turns. We also increased the sweep of the wing tips, strengthened the seams and upgraded to the latest XT material by Teijin for the leading edge and struts. The WS is your ticket to the green room.

/ PERFORMANCE *Features*

- Three strut Open-C Hybrid design
- High-performance kite for wave, freeride and foil kiting
- Rapid and direct pivot turning characteristics
- Stable downwind drift for carefree surfing
- Medium aspect ratio for huge wind range and low end
- Light bar pressure for single hand control
- New bridle system with added trim option for customized performance
- Superior materials like X4 canopy and XT cloth made by Techno Force™

/ DESIGNER *Quote*

The WS kite design is a surf specialized wing with outstanding and intuitive handling. Its turning character and drift ability makes him the perfect companion in all wave conditions.

Peter Stiewe



Turquoise: 313



Red: 317



Yellow: 319



/ RIDING Style

Surf	●	●	●	●	●	●
Freeride	●	●	●	●	●	●
Strapless Freestyle	●	●	●	●	●	●
New to the sport	●	●	●	●	●	●
Light Wind Foil	●	●	●	●	●	●

/ WIND Range

Size / Knots 6 8 10 12 14 16 18 20 22 24 26 28 30 32 34 36 38

05 m								●	●	●	●	●	●	●	●		
06m					●	●	●	●	●	●	●	●	●	●	●	●	
07 m				●	●	●	●	●	●	●	●	●	●	●	●	●	
08 m			●	●	●	●	●	●	●	●	●	●	●	●	●	●	
09 m			●	●	●	●	●	●	●	●	●	●	●	●	●	●	
11 m		●	●	●	●	●	●	●	●	●	●	●	●	●	●	●	
13 m	●	●	●	●	●	●	●	●	●	●	●	●	●	●	●	●	

Based on average rider weight of 75kg/165 lbs

Beaufort	2	3	4	5	6	7	8
Description	Light breeze	Gentle breeze	Moderate breeze	Fresh breeze	Strong breeze	High wind, moderate	Strong wind

/ CHANGES for 2020

- Flattened arc for more low end performance and optimized power generation in turns
- Additional kite sizes to complete quiver
- More sweep in the wing tips for better upwind and low end performance
- New five-point bridle system for increased stability and linear bar feel
- Additional trim option in the front bridles allows customization of turning behavior
- Redefined trailing edge load diffuser reduces flutter and improves durability
- Thinner battens for less weight
- New load dynamic super seam to increase durability and avoid seam damage
- New Extreme Tenacity LE and strut material by Techno Force™
- New bridle deflector to cover the LE closing seam

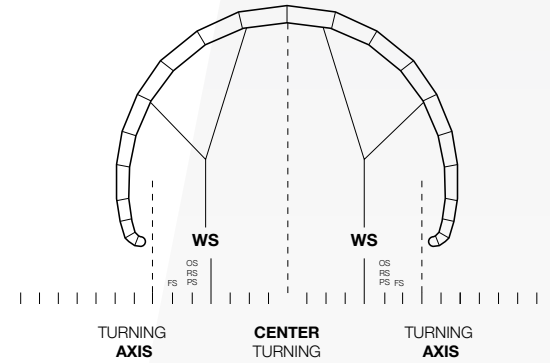

TURNING CHARACTERISTIC

- Extreme fast turn
- Pivot turner
- Direct drift turn

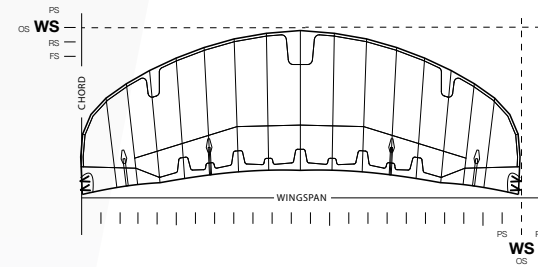

ASPECT RATIO

- Medium AR
- Stable downwind drift
- Gust absorber

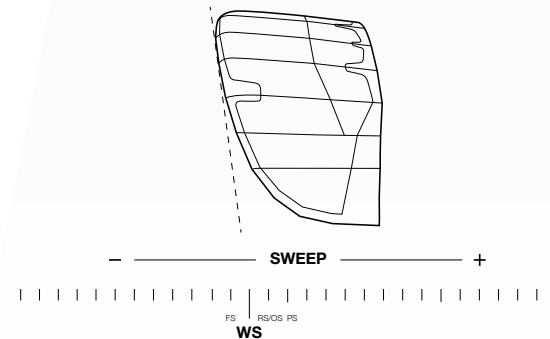

SWEEP

- Medium to low sweep
- Controlled power
- Direct handling

OS

FOIL
LIGHTWIND
SERIES



Rider: Team Eleveight
Picture: Olivier Sebbar

OSFOIL
LIGHTWIND
SERIES

TECHNO FORCE X4 XT

**SIZES**

06 / 08 / 10 / 12 / 14

/ DESIGN Vision

Our brand new dedicated foil and freeride kite, the OSeries, redefines durable and sturdy built quality with a feather-light design. The one strut Open-C Hybrid design with a medium aspect ratio and medium swept wing tips takes off in the lightest breeze and allows riders to hit the water in well below 10 knots. Get ready to always be the first one out there and to never again wait for the wind to pick up. The OS is extremely fast but at the same time easy to tame as it is very responsive and has a smooth power generation. Furthermore, we eliminated backstall and made it remarkably stable. We spent more than three years on the development of the OS and are very proud of the result. Choose the OS and take off in any breeze.

/ PERFORMANCE Features

- One strut mid-swept hybrid design
- High-performance wing for foiling and freeride
- Ultra responsive and dynamic turning speed
- Medium aspect ratio optimized for light wind usage
- Medium sweep for low end performance and backstall prevention
- Outstanding stability in all conditions
- Feather-light design paired with an extra durable construction
- Superior materials like X4 canopy and XT cloth made by Techno Force™

/ DESIGNER Quote

The OS is a light and reactive kite, supporting you to hit the water in a gentle breeze foiling, freeriding or taking you in the surf.

Peter Stiewe



Grey: 512



FOIL
LIGHTWIND
SERIES

TECHNO FORCE X4 XT



/ RIDING Style

Light wind	●	●	●	●	●	●
Freeride	●	●	●	●	●	●
School	●	●	●	●	●	
Jump	●	●	●	●		
Surf	●	●	●	●		

/ WIND Range

Size / Knots 6 8 10 12 14 16 18 20 22 24 26 28 30 32 34 36 38

06 m				●	●	●	●	●	●	●	●	●	●			
08 m			●	●	●	●	●	●	●	●	●	●	●			
10 m		●	●	●	●	●	●	●	●	●	●	●	●			
12 m	●	●	●	●	●	●	●	●	●	●	●	●	●			
14 m	●	●	●	●	●	●	●	●	●	●	●	●	●			

Based on average rider weight of 75kg/165 lbs

Beaufort	2	3	4	5	6	7	8
Description	Light breeze	Gentle breeze	Moderate breeze	Fresh breeze	Strong breeze	High wind, moderate	Strong wind

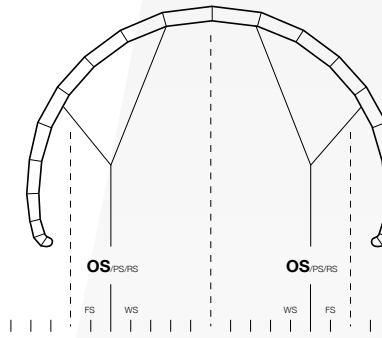

TURNING CHARACTERISTIC

- Fast and responsive turning speed
- Pivot to wingtip turner
- Medium power drift turn

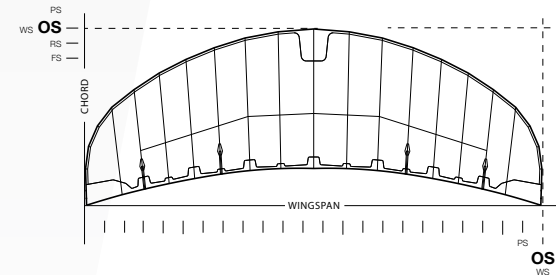

ASPECT RATIO

- Medium AR
- Big wind window range
- Outstanding lightwind performance

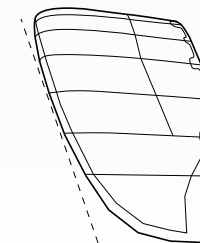

SWEEP

- Medium sweep
- Balanced power generation
- Smooth lift and acceleration

Eleveight kites are built with innovative and quality workmanship. Details are strategically designed for long lasting durability, while keeping the kite light and agile.

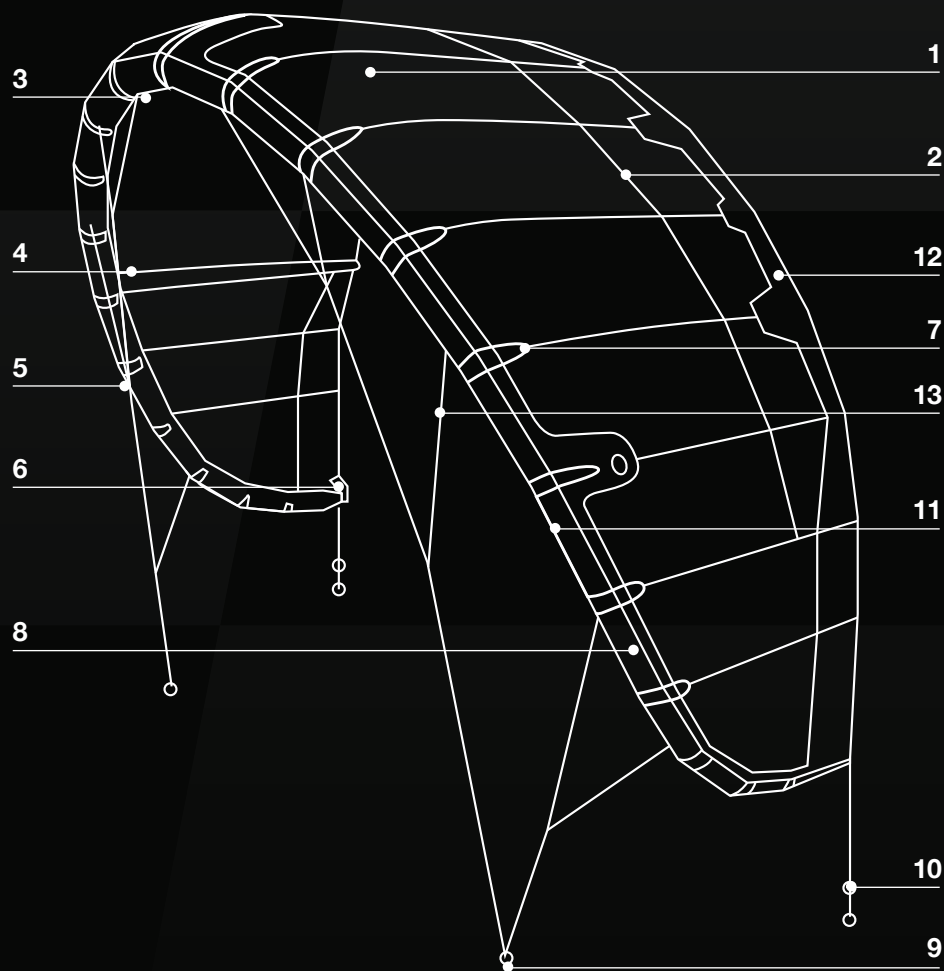

KITE STRUCTURE

E/8 TRUSTED QUALITY / RS / FS / WS / OS

1 / Teijin Techno Force™ - X4 Ripstop canopy

The superior X4 Ripstop canopy is strong and tear resistant. It is made by Teijin Techno Force™ in Japan and guarantees lasting performance.

2 / Double Bond Canopy

To ensure your kite can take a beating, every seam is glued and stitched for maximum durability.

3 / Quick Flow

The large diameter of the valve and strut connectors ensures easy and fast inflation and deflation of your kite.

4 / Strut Force Distribution

Double strut head reinforcement for a solid and robust kite frame.

5 / Short bridle

The short bridle setup with only one wingtip pulley enhances the kite's agility and the direct bar feeling while reducing the risk of catching the wingtip.

6 / 3D bridle deflector

Redesigned 3D bridle deflector with structural reinforcement covering the closing seam, decreasing the possibility of bridle wraps.

7 / Canopy Guards

Strategic Dacron canopy reinforcements to eliminate canopy wear and tear including pin holes caused by the valves.

8 / German made PU Bladder Material

The lightest and most durable bladder material on the market. Quality made in Germany.

9 / Safe Connect

Avoid mixing up lines with the kook proof front- and backline connection points.

10 / Easy Trim

Trim the kite's flying behavior to suit your needs. Simply switch between backline trim options with the pull-to-pull tags.

11 / Load dynamic super seam

A triple reinforced closing seam along the leading edge makes it practically indestructible. The center segments have a stronger reinforcement as the material load is much higher, compared to the wingtips with their smaller diameter.

12 / Load Diffuser

Angled reinforcements along the trailing edge diffuse the load and strain on the canopy, making it more durable while improving kite stability and longevity.

13 / Turning Trim Setting

Trim the kite according to your riding style and wind conditions by switching between different bridle line turning settings.

Canopy Composition

RIPSTOP FABRIC BY TEIJIN

- Ultra high tenacity polyester yarn

X4 RIPSTOP WEAVE

- 4 x 4 Ripstop yarn with outstanding performance and Quality

LATEST TEIJIN COATING

- High temperature resin finish including UV filter

Performance Results

LESS ELONGATION

- Less stretch in all directions (0°, 90° & +/- 45°)
- Results in precise and responsive flight characteristics

Quality Results

LONG LASTING QUALITY

- Extreme rip protection against peak loads, tears and punctures
- Less elastic fatigue
- Enhanced durability with less wear and tear
- Increased longevity

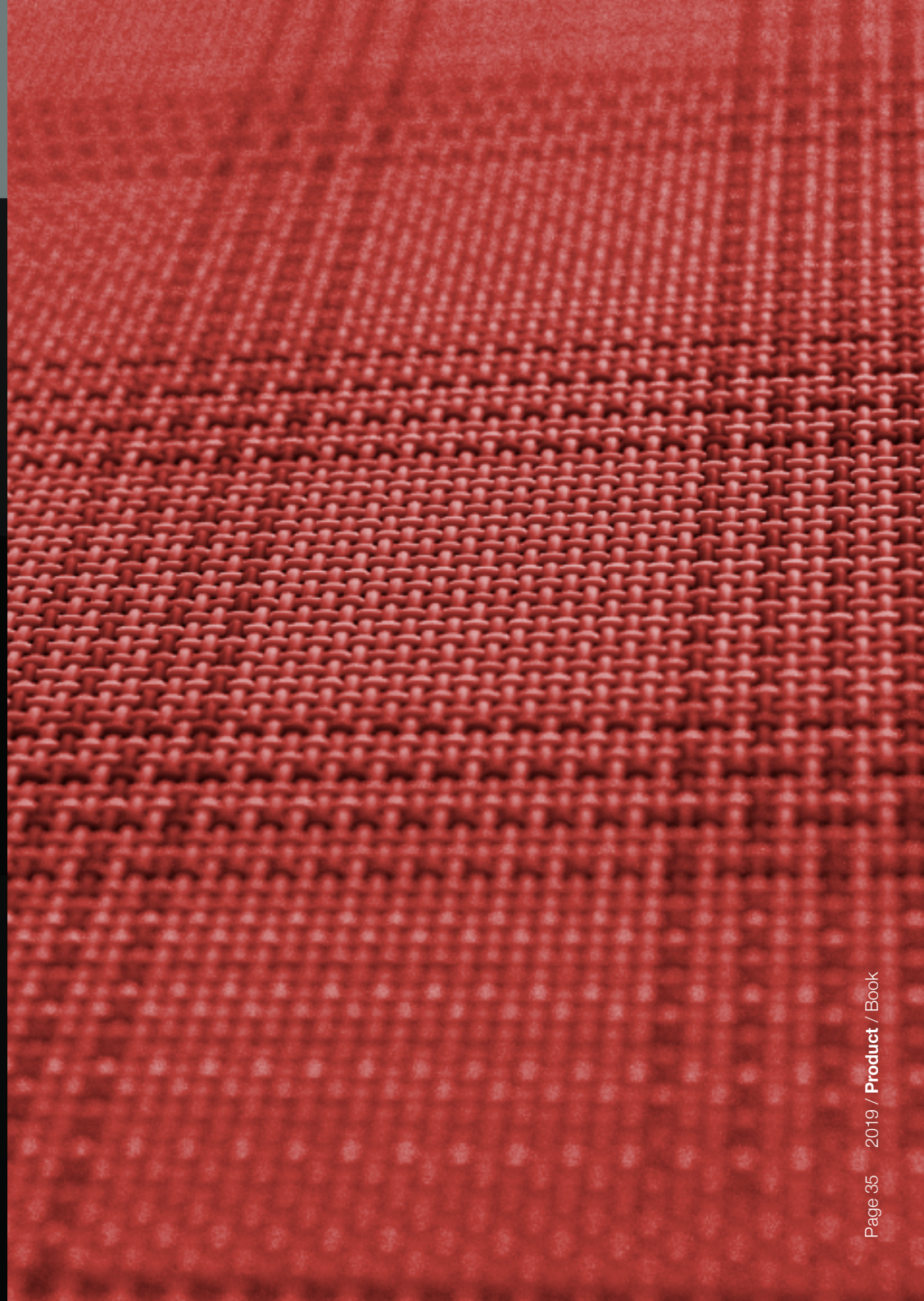





/ DESIGN *Vision*

The third generation of the PS is the most durable and stable one. This kite is our recommended weapon of choice for schools and those seeking to progress. It has accessible and forgiving flying characteristics with a moderate steering speed. We implemented leading safety features and paid special attention to design the kite for heavy-duty usage. The shape provides an automatic relaunch, greatly enhancing the riding time for those in training. Its power and performance are readily available, allowing beginners to instantly score winnings and instructors to boost big. The PS is pure fun and gets anyone addicted to kiteboarding.

/ PERFORMANCE *Features*

- Three strut swept hybrid design
- Low to medium aspect ratio
- Very smooth and controllable turning speed
- Excellent power distribution with great upwind performance
- Ultra-stable and forgiving
- Fast and easy automatic relaunch
- Safe-to-fly-features such as our innovative tangle-free bridle setup
- Heavy-duty kite with strong reinforcements

/ DESIGNER *Quote*

We are proud of the PS as it makes kiteboarding accessible to a broad audience. Its stability, forgiving performance and its many safety features accelerate progression.

Peter Stiewe

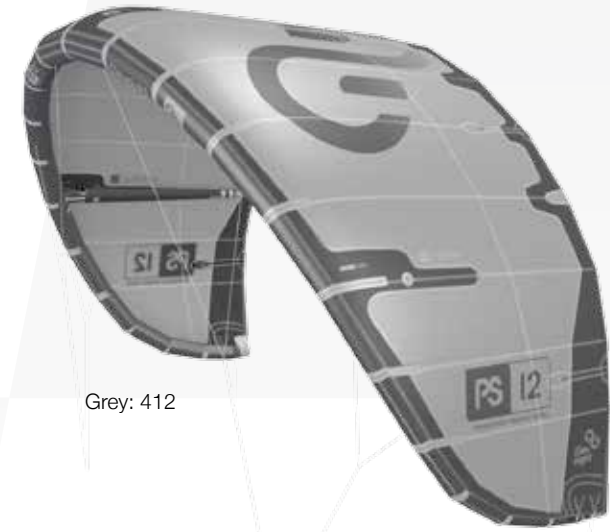

Grey: 412



Blue: 415



Red:417



Yellow: 419



/ RIDING Style

Progression	●	●	●	●	●	●
Freeride	●	●	●	●	●	●
School	●	●	●	●	●	●
Jump	●	●	●	●		
Surf	●	●	●	●		

/ WIND Range

Size / Knots 6 8 10 12 14 16 18 20 22 24 26 28 30 32 34 36 38

04 m										●	●	●	●	●	●	●
06 m							●	●	●	●	●	●	●	●	●	●
08 m				●	●	●	●	●	●	●	●	●	●	●	●	●
10 m			●	●	●	●	●	●	●	●	●	●	●	●	●	●
12 m		●	●	●	●	●	●	●	●	●	●	●	●	●	●	●
14 m	●	●	●	●	●	●	●	●	●	●	●	●	●	●	●	●

Based on average rider weight of 75kg/165 lbs

Beaufort	2	3	4	5	6	7	8
Description	Light breeze	Gentle breeze	Moderate breeze	Fresh breeze	Strong breeze	High wind, moderate	Strong wind

/ CHANGES for 2020

- Redefined delta for even easier relaunch
- 14m Size has less diameter in the inflatable structure for better light wind performance
- New Extreme Tenacity LE and strut material by Techno Force™
- New bridle deflector to cover the LE closing seam
- New canopy reinforcement along strut-canopy seam to protect canopy in crash and relaunch situation
- New Load dynamic super seam to increase durability and avoid seam damage

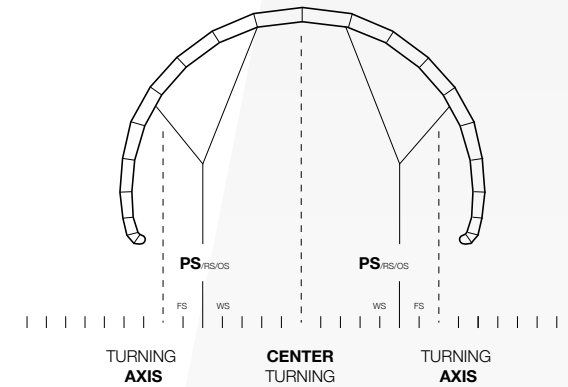

TURNING CHARACTERISTIC

- Medium turning speed
- Constant and smooth pulling turn
- Wingtip to pivot turner

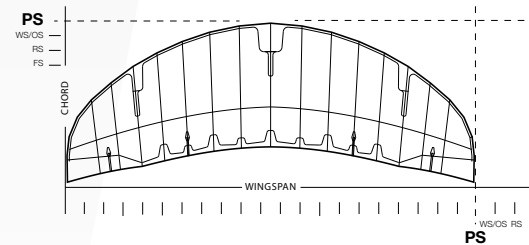

ASPECT RATIO

- Medium to low AR
- High flight stability
- Constant power

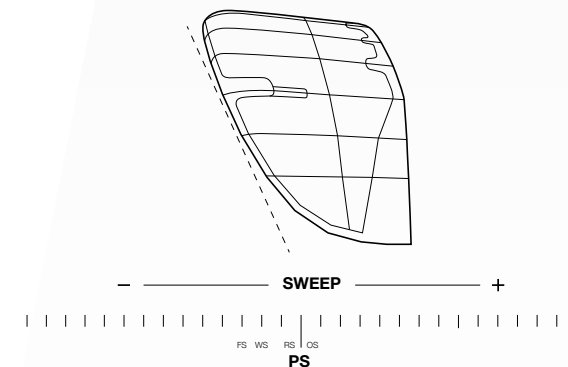

SWEEP

- High sweep
- Automatic relaunch
- Predictable handling

Eleveight kites are built with innovative and quality workmanship. Details are strategically designed for long lasting durability, while keeping the kite light and agile.

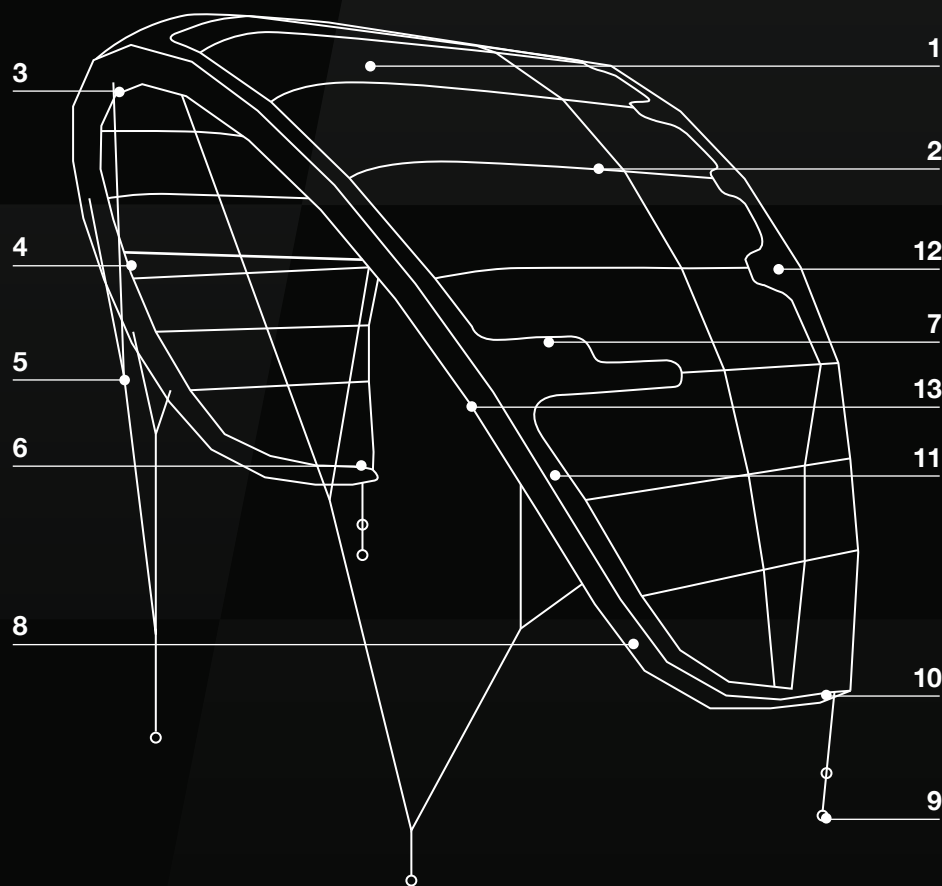

E/8 TRUSTED QUALITY / PS

1 / Techno Force™ D2 Ripstop

Eleveight kites are built with the highest quality materials out there such as the Techno Force™ D2 Ripstop from Japan for best performance and durability.

2 / Double Bond Canopy

To ensure your kite can take a beating, every seam is glued and stitched for maximum durability.

3 / Quick Flow

The large diameter of the valve and strut connectors ensures easy and fast inflation and deflation of your kite.

4 / Strut Force Distribution

Double strut head reinforcement for solid inflatable kite frame.

5 / Short bridle

The short bridle setup with only one wingtip pulley enhances the kite's agility while providing a direct bar feeling and less risk off bridle catch.

6 / 3D bridle deflector

Redesigned 3d bridle deflector with structural reinforcement covering the closing seam, decreasing the possibility of bridle wraps.

7 / Canopy Guards

Strategic Dacron canopy reinforcements to eliminate canopy wear and tear including pin holes caused by the valves.

8 / German made PU Bladder Material

The toughest and lightest bladder material available, made in Germany.

9 / Safe Connect

Avoid mixing up lines with the kook proof front- and backline connection points.

10 / Easy Trim

Fly the kite your way by easily switching between backline trim options with the pull to pull tags.

11 / Load dynamic super seam

A triple reinforced closing seam along the leading edge makes it practically indestructible. The Center segments with a bigger diameter and a higher material load have a stronger reinforcement compared to the tips with smaller diameter where more twist is needed.

12 / Load Diffuser

Angled reinforcements along the trailing edge diffuse the load and strain on the canopy, making it more durable, improving kite stability and increasing the longevity.

13 / Leading Edge Guards

Additional leading edge TPU reinforcements for further wear and tear protection

TRAINER KITE



SIZES
2.5

/ DESIGN VISION

Our Eleveight Trainer Kite is perfect for newcomers to enter the sport of kiting. It allows anyone to learn how to handle a kite in a safe and enjoyable way. The RAM-Air design is very easy to handle, robust enough to survive almost any misuse, stable in all wind conditions and it has safe launch and landing characteristics. The 2-line aluminium bar is easy to rig and comes with a convenient wrist leash. Similar to all Eleveight products we build the trainer kite with highest attention to quality and durability.

/ PERFORMANCE FEATURES

- RAM-Air Kite
- 2-line control bar with safety leash
- Easy handling and simple set up
- No previous kite experience required
- Compact kite bag for easy travel
- High flight stability and wide wind range
- E8 trusted quality

/ WIND Range

Size / Knots 6 8 10 12 14 16 18 20 22 24 26 28 30 32 34 36 38



Based on average rider weight of 75kg/165 lbs

Beaufort	2	3	4	5	6	7	8
Description	Light breeze	Gentle breeze	Moderate breeze	Fresh breeze	Strong breeze	High wind, moderate	Strong wind

/ DESIGNER QUOTE

We develop a trainer kite to get an easy feel for kite control and handling, so that you learn the essential skills faster and safer than ever before.

Peter Stiewe



ELEVEIGHT BACKPACK

Each kite comes in a trendy back bag that is comfortable to carry, fits additional equipment and can be used apart from kiting.

- Comes in two sizes and easily fits two kites.
- Perfect as cabin luggage and for activities other than kiteboarding.
- Equipped with kite repair kit and user guide.
- Clips the bar bag and has a spare pocket for additional gear.
- Pump straps

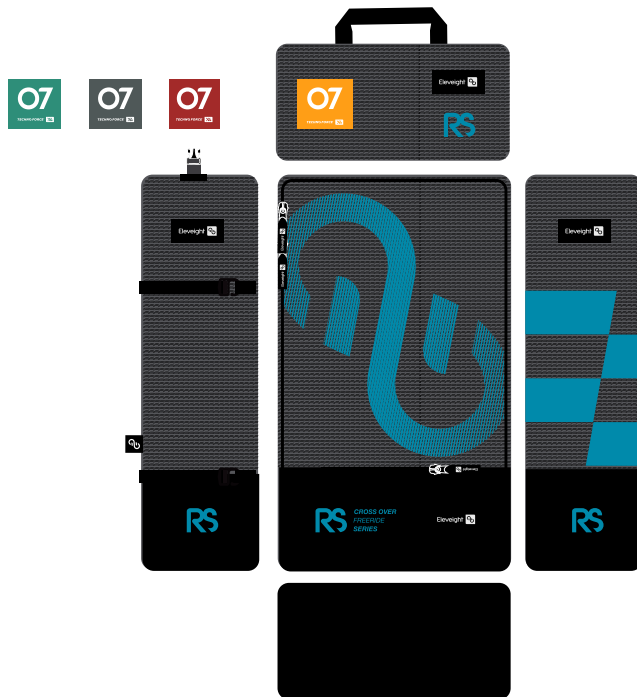

KITE FINDER



	Freestyle / Newschool	Freestyle / Big Air	Crossover / Freeride		Wave
FS / Freestyle Series	■ ■	■ ■ ■ ■	■ ■		
RS / Crossover Series		■ ■ ■	■ ■ ■ ■ ■ ■ ■ ■ ■ ■		■ ■ ■
WS / Wave Series				■ ■ ■ ■ ■ ■ ■ ■ ■ ■	■ ■ ■ ■ ■ ■ ■ ■ ■ ■
OS / Foil Light Wind Series			■ ■ ■ ■ ■ ■ ■ ■ ■ ■	■ ■ ■ ■ ■ ■ ■ ■ ■ ■	■ ■ ■ ■ ■ ■ ■ ■ ■ ■
			Progression / Freeride	School / Beginner	
PS / Progression Series		■ ■ ■	■ ■ ■ ■ ■ ■ ■ ■ ■ ■	■ ■ ■ ■ ■ ■ ■ ■ ■ ■	■ ■ ■
TRS / Trainer / Beginner Series				■ ■ ■ ■ ■ ■ ■ ■ ■ ■	

CS

VARY BAR
CONTROL
SERIES



Rider: David Tonijuan Colomer
Picture: Flotat Samuel

CS**VARY BAR
CONTROL
SERIES****QUICKMATIC SYSTEM****SIZES**

Small (42/50cm)

Large (47/55cm)

/ DESIGN VISION

Our four line CS Vary bar is fine-tuned for the precise steering of all Eleveight kites. Everything about this bar is made in regards to safety, control, and comfort. The bar features a single front line safety system and the most innovative QR on the market which acs all international safety tests. A low V and thermo-coated performance lines from Germany enhance reactivity and ensure direct control. The CS Vary bar's slick stick is designed to reduce strain on the hands, enabling the rider to enjoy extra-long sessions. Among other changes, we introduce a red line swivel and a new single depower line. The latter comes with a strong inner core and a spliced Spectra coating, that reduces friction and extends durability. The CS Vary elevates safety and control to new heights.

/ PERFORMANCE FEATURES

- Four line bar with single front line safety
- Spliced Spectra single depower line for less friction
- Innovative Quick-Matic release system with top swivel
- Variable integrated bar ends to adjust bar width
- Ergonomic anti-slip EVA grip pattern for comfort and control
- Thermo-coated high-performance lines made in Germany
- Short safety leash included

/ DESIGNER QUOTE

The CS Vary's design is very slick and functional and features outstanding safety, control and comfort characteristics.

Team Eleveight

Red / Grey



Grey



/ CHANGES for 2020

- New single depower line with a strong inner core and spliced Spectra cover for enhanced durability, less friction, better feedback, and higher comfort
- New red line swivel below the QR to untwist the red line for tangle free usage
- New spliced line ends for stronger connection and longevity with exchangeable pig tails

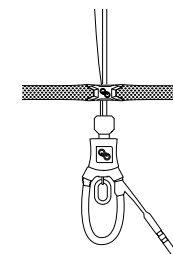
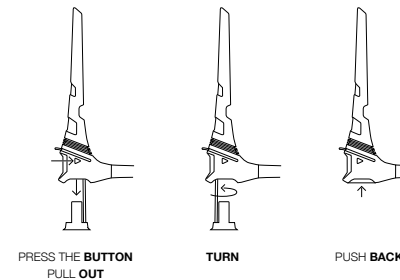
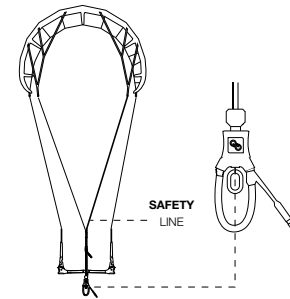
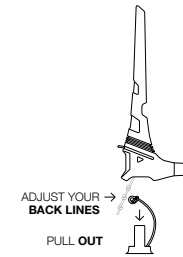
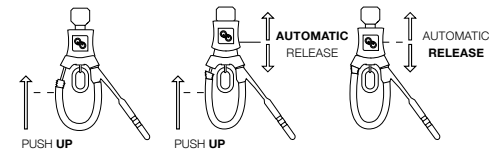

QUICK MATIC

- French norm safety compliance
- Intuitive system
- Easy and fast assembling

EASY LINE ADJUSTEMENT

- Backline adjuster integrated in the bar ends
- Long depower range

SINGLE FRONT LINE SAFETY

- Most reliable system
- Safest way to release
- Easy to assemble

CS VARY FUNCTION

- Easy change between bar width
- Large: range from 47 – 55 cm
- Small: range from 42 – 50 cm

SINGLE DEPOWER LINE

- Spectra line with additional spliced Spectra coating decreases abrasion
- Less friction equals better bar feedback
- Comfortable single-handed riding

Eleveight bars are designed in an innovative development process and manufactured with quality materials and leading workmanship. They are designed for long lasting durability and safe and functional handling.

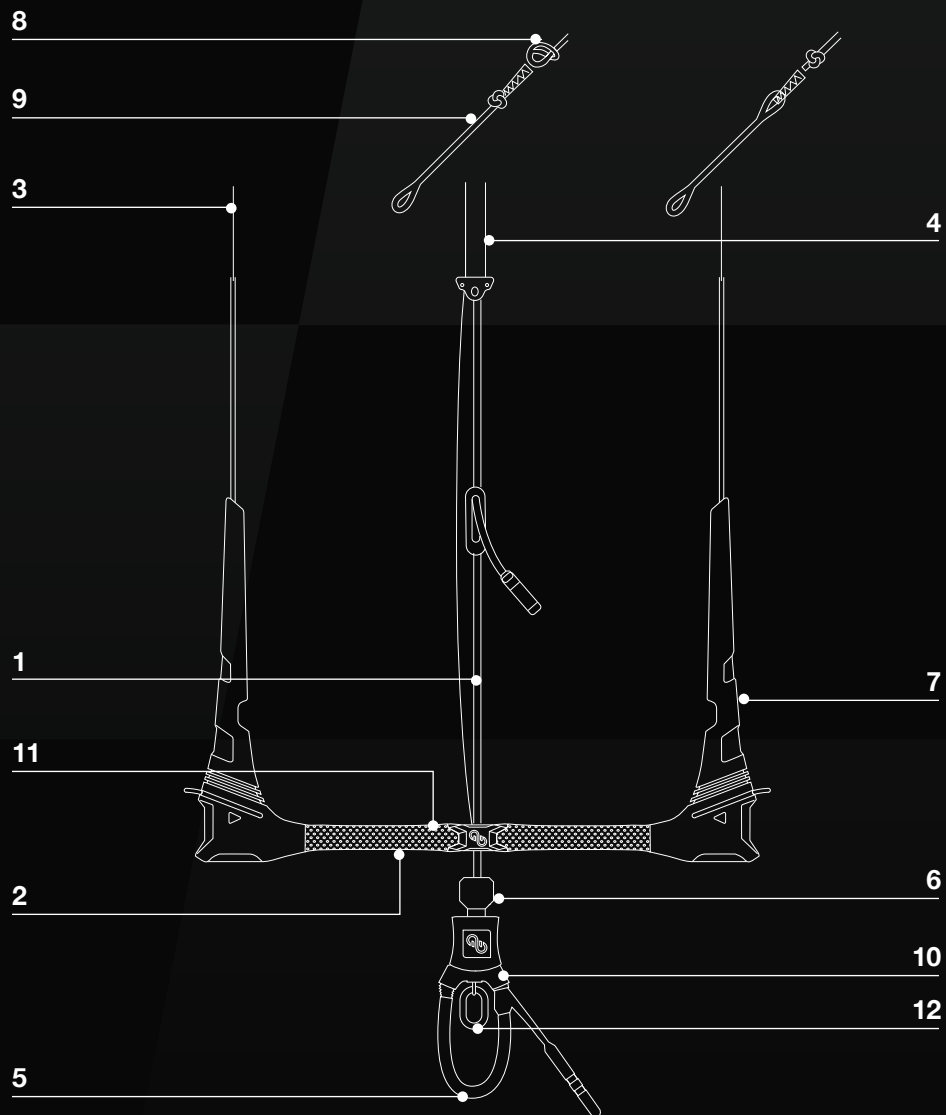

BAR STRUCTURE

E/8 TRUSTED QUALITY / BAR

1 / Single depower line with a double layer

The single depower line is made out of two layers of wear and tear resistant high-quality Spectra fibers. The outer layer made of spliced Spectra covers a strong inner Spectra core. The single depower line offers frictionless bar feedback and maximum durability.

2 / Ergonomic EVA grip

Double density EVA grip for enhanced control and comfort.

3 / Thermo-coated 22m Spectra lines

High quality spectra lines made in Germany. They are stretch resistant and have a break load of more than 200 kg.

4 / Low V Position

The low V (this is when the front lines split close to the bar instead of higher towards the kite) increases the reactivity and the power of the kite.

5 / Small Chicken Loop

Small custom moulded freeride chicken loop for safe riding and the largest depower range possible.

6 / Mounted Swivel

The swivel below the bar allows easy untwist of the front lines after loops and rotations. It is made of high density Polyethylene for long-lasting durability.

7 / EVA Floater Protection

The EVA floaters offer the best protection of the lines and the rider.

8 / Safe Connect

Avoid mixing up lines with the kook proof front- and backline connection points.

9 / Spliced and stitched line ends

The line ends, now equipped with pigtails, ensure the strongest and safest connection between bar and kite. They are incredibly durable.

10 / High Quality Metal and Plastics in all QR parts

316 Marine grade stainless steel and impact resistant Polyethylene ensure efficiency and durability of the safety release system.

11 / Reduced diameter bar stick

The thinner bar stick combined with the new anti-slip EVA grip provides the maximum in control and comfort.

12 / Red line swivel

To avoid tangle or twist of our red safety line we added an extra swivel on the safety leash attachment point.

IGNITION

PROGRESSION FREERIDE



Rider: Philippe Martin
Picture: Flotat Samuel

IGNITION

PROGRESSION FREERIDE



SIZES
150 x 46

/ DESIGN VISION

The Ignition will spark anyone's love for kiteboarding. The beginner-friendly progression twin tip incorporates leading technology that comes with a long list of features and advantages. Most prominently: the outstanding planing and upwind performance which makes it a favorite for schools and heavy riders in light wind. This is achieved by the board's elaborate but straightforward outline and bottom shape. The Paulownia wood core and top sheet design deliver a flex pattern that provides direct feedback to the rider, ensuring a smooth ride and full control even in rough conditions. The board is built extra sturdy and always fun to ride. It forms the perfect symbiosis with the PS, our recommended tools to accelerate any riders progression. All in all, the Ignition is the perfect companion from the first meters ridden till stomping technical freeride tricks.

/ PERFORMANCE FEATURES

- Progressive Freeride twin tip with excellent lightwind performance
- Lightweight Paulownia wood core for balanced flex and durability
- Early planing for light wind fun and heavier riders
- Single concave for more lift and control
- Reinforced inserts used in snowboard construction
- Ultra-durable top sheet with UV resistance
- Airgo pads and straps
- 45mm G10 fins

/ DESIGNER QUOTE

Everything is difficult before it gets easy – the Ignition eleveights your way.

Franz Schitzhofer



IGNITION

PROGRESSION FREERIDE



/ RIDING Style

Freestyle / hooked	● ● ●
Wakestyle (unhooked)	● ●
Freeride	● ● ● ● ●
New to The Sport	● ● ● ● ● ●
Light Wind	● ● ● ● ● ●

/ TECH CONSTRUCTION

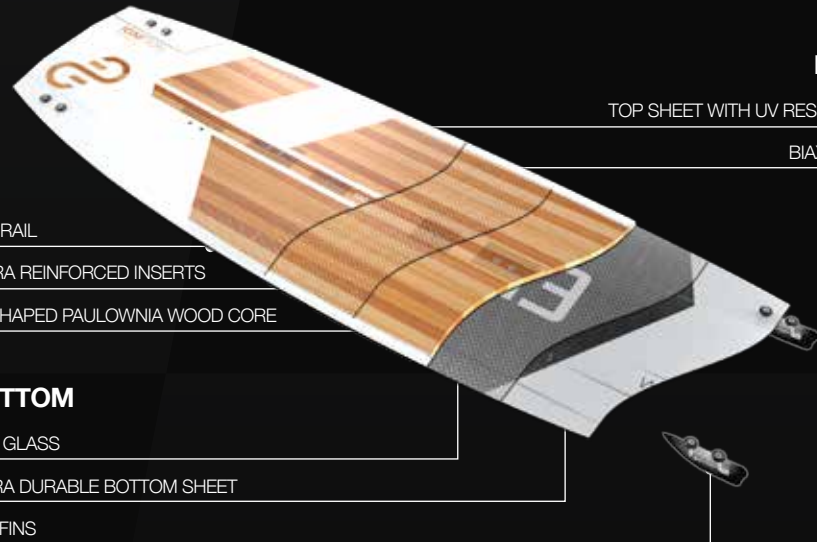

DECK

TOP SHEET WITH UV RESISTANCE

BIAX GLASS

ABS RAIL

EXTRA REINFORCED INSERTS

3D SHAPED PAULOWNIA WOOD CORE

BOTTOM

BIAX GLASS

ULTRA DURABLE BOTTOM SHEET

G10 FINS

LENGTH	WIDTH	RIDER WEIGHT	FINS	BOARD WEIGH IN KG
150	46	65+ KG	G10 fins / 45mm	3.05

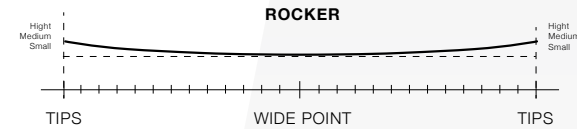

ROCKER

- Medium 3 stage rocker
- Early planing
- Superb upwind ability

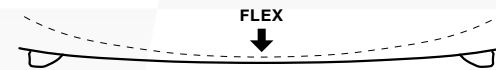

FLEX

- Optimized flex pattern for bigger board sizes
- Well balanced between comfort and performance

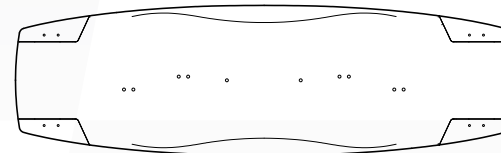

OUTLINE

- Modern outline with rounded tips
- Outstanding carving ability for heavier riders
- Box rail for better grip and durability



BOTTOM SHAPE

- Single concave with tip canals
- Railsteps for more grip
- Less drag and more lift for early planing

PROCESS

PERFORMANCE FREERIDE



Rider: Philippe Martin
Picture: Flotat Samuel

PROCESS

PERFORMANCE FREERIDE



SIZES

132 x 39.5 / 135 x 41 / 139 x 42.5 / 144 x 44

/ DESIGN VISION

The Process combines dynamic and easily accessible performance characteristics, ultra-durable built quality and excellent riding comfort. Tailored to the needs of freeriders it stands out when it cuts through chop and cushions heavy landings, and when it comes to board control and pop. Franz Schitzhofer implemented elaborate features and high-tech materials for the rider to enjoy the session, no matter the conditions. For this year we improved the flex pattern with an innovative Carbon fusion technology making it even more comfortable and performance-oriented. We also updated the fin design and graphics. The Process is always fun, no matter the conditions.

/ PERFORMANCE FEATURES

- Twin tip for highest freeride performance
- Lightweight paulownia wood core with well-balanced flex pattern
- 50mm Carbon Stringer reinforcement for smooth landings and superior carving
- Optimized rocker line for early planing and dashing speed
- Progressive channel design provides superb grip and control
- Implementation of snowboard tech for highest performance and durability
- Ultra-durable top sheet with UV resistance
- High-quality pads and straps and 45 mm G10 fins come included

/ DESIGNER QUOTE

The Process – concentrate on what really counts in kiting – FUN!

Franz Schitzhofer



PROCESS

PERFORMANCE FREERIDE

/ RIDING Style

Freestyle / hooked	● ● ● ●
Wakestyle (unhooked)	● ● ●
Freeride	● ● ● ● ● ●
New to The Sport	● ● ● ● ●
Light Wind Race	● ● ● ●

/ TECH CONSTRUCTION

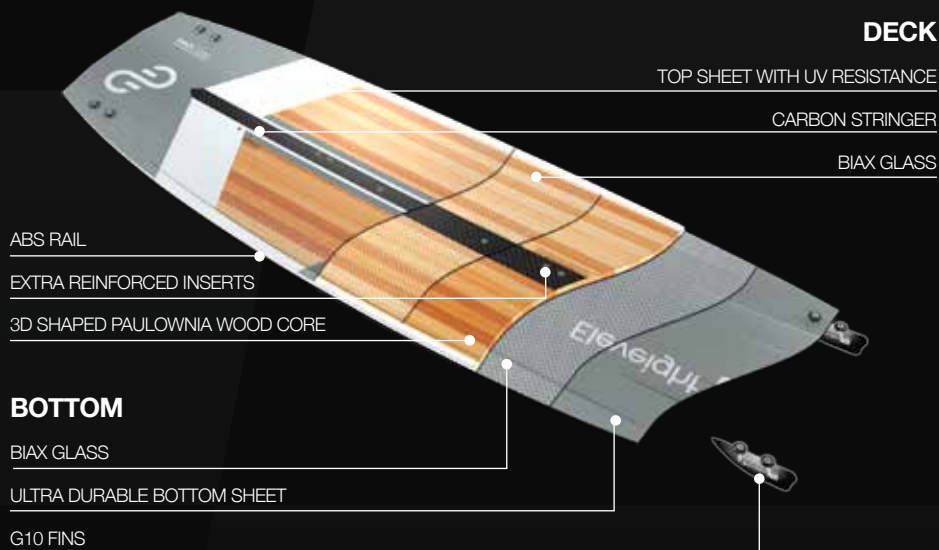

DECK

TOP SHEET WITH UV RESISTANCE

CARBON STRINGER

BIAX GLASS

ABS RAIL

EXTRA REINFORCED INSERTS

3D SHAPED PAULOWNIA WOOD CORE

BOTTOM

BIAX GLASS

ULTRA DURABLE BOTTOM SHEET

G10 FINS

LENGTH	WIDTH	RIDER WEIGHT	FINS	BOARD WEIGH IN KG
132	39.5	>65kg	G10 fins / 45mm	2.50
135	41	60-75 KG	G10 fins / 45mm	2.60
139	42.5	70-95 KG	G10 fins / 45mm	2.70
144	44	> 75 KG	G10 fins / 45mm	2.95

/ CHANGES for 2020

- Innovative Carbon fusion technology for improved flex pattern
- Redefined fin design
- Updated graphics for more exciting look
- Revised ABS rail with higher impact resistance

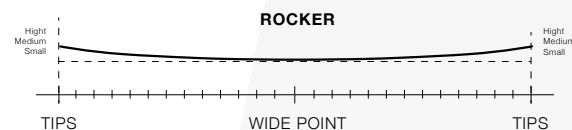

ROCKER

- Medium 3 stage rocker
- Great pop and release
- Early planing and superb upwind ability

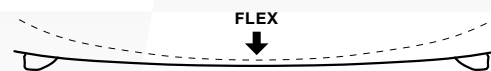

FLEX

- Optimized flex patterns for each size
- Well balanced between comfort and performance
- Harder Reverse flex for better carving and landing

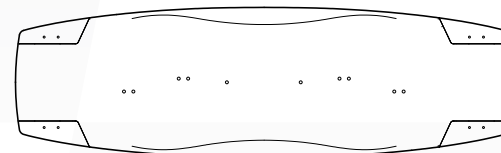

OUTLINE

- Elliptic outline with rounded tips
- less splash water
- Outstanding carving ability
- Box rails for better grip and durability



BOTTOM SHAPE

- Single concave with tip canals
- Railsteps for more grip
- Less drag for early planing

MASTER

PERFORMANCE FREESTYLE



Rider: David Tonjuan Colomer
Picture: Rimondi / instants numériques

MASTER

PERFORMANCE FREESTYLE



SIZES
136 x 41 / 139 x 42 / 142 x 43

/ DESIGN VISION

The Master is our proven freestyle and freeride shred-stick, made to stomp the most technical tricks and cushion the landings of staggering big airs. It is a board addressed to advanced riders while being accessible to a wide audience of riders. The innovative design is paired with highest-quality materials and superior craftsmanship. Franz Schitzhofer implemented renowned features used in snowboard constructions and tweaked the flex pattern to perfection using a new Carbon fusion technology. Go out there and Master your tricks!

/ PERFORMANCE FEATURES

- Performance freestyle and freeride twin tip
- 3D shaped Paulownia wood core for an outstanding flex pattern
- Carbon reinforcements reducing torsional flex and creating balanced rebound
- Rail steps and multi channels for control and speed
- Multi-stage rocker for better pop and smooth landings
- Heavy-duty plywood block inserts
- Shock-proof and UV resistant top sheet
- 45 mm G10 fins come included

/ DESIGNER QUOTE

The Eleveight Master is the last stage of a 15-year development process – a masterpiece I'm proud of. That's it – That's all!

Franz Schitzhofer



MASTER

PERFORMANCE FREESTYLE

/ RIDING Style

Freestyle / hooked	● ● ● ● ● ●
Wakestyle (unhooked)	● ● ● ● ● ●
Freeride	● ● ● ● ●
New to The Sport	● ● ●
Light Wind Race	● ●

/ TECH CONSTRUCTION

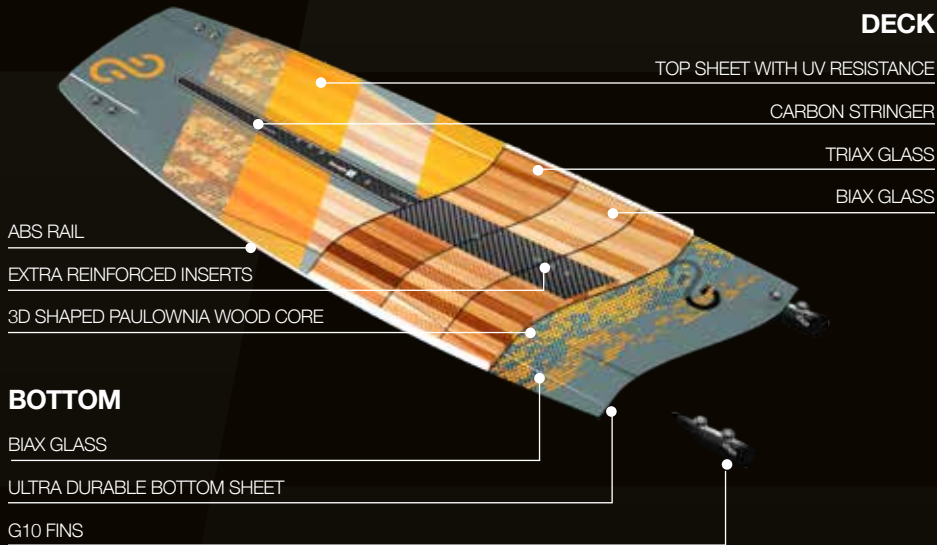

LENGTH	WIDTH	RIDER WEIGHT	FINS	BOARD WEIGH IN KG
136	41	55-80 KG	G10 fins / 45mm	2.55
139	42	65-90 KG	G10 fins / 45mm	2.65
142	43	> 75 KG	G10 fins / 45mm	2.80

/ CHANGES for 2020

- Innovative Carbon fusion technology for improved flex pattern
- Revised ABS rail with higher impact resistance
- Redefined fin design

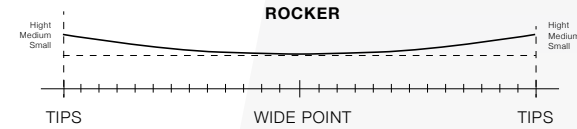

ROCKER

- Multi stage rocker
- Increased grip and pop
- Great upwind performance and early planing



FLEX

- Medium flex through center and tips
- Optimized flex patterns for each size
- Eats the chop
- Harder reverse flex and reduced torsional flex

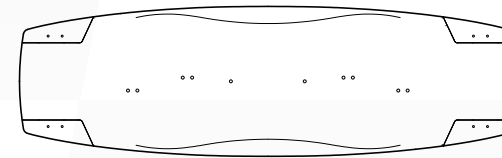

OUTLINE

- Elliptic outline with rounded tips
- Great carving ability
- Smooth ride design
- High Impact box rail for better grip and durability



BOTTOM SHAPE

- Double concave with rail steps
- Deep tip channels for more pop
- Rail steps for more grip and upwind ability

MASTER C+

PERFORMANCE FREESTYLE

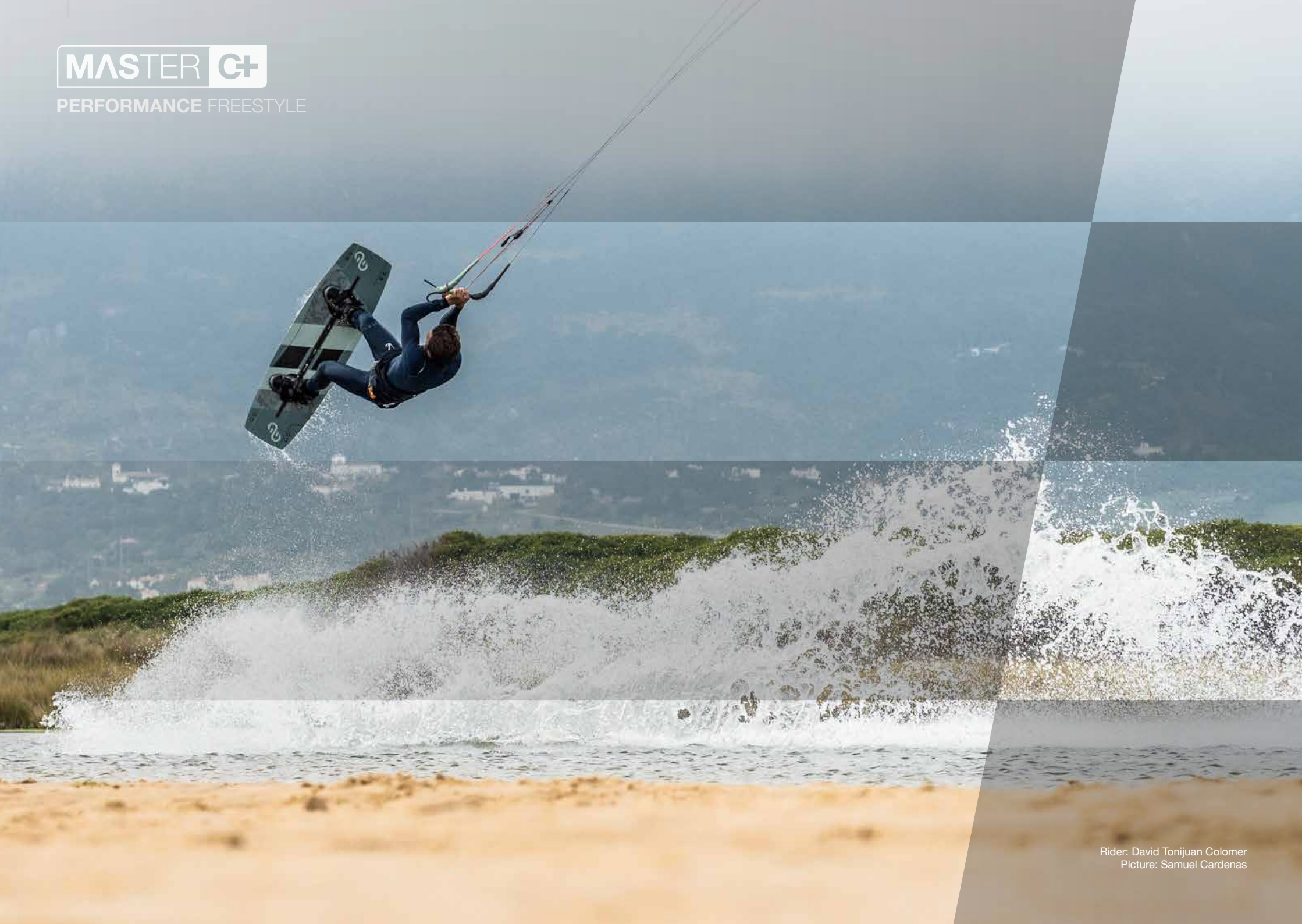

Rider: David Tonijuan Colomer
Picture: Samuel Cardenas

MASTER C+

PERFORMANCE FREESTYLE

/ DESIGN VISION

In the last two years, the Master's freestyle and big air design was widely successful. Riders praised the amazing pop for technical tricks and the extreme control in heavy storms and after landing radical loops. To stay true to those features and also to emphasize the freeride characteristics, we translated the design to an all carbon construction. Using aerospace grade Spread Tow Carbon, we managed to make the Master our lightest board in the lineup, brimming with technology and superior craftsmanship. Board expert Franz Schitzhofer was given full rein to make this board stand out in every situation. It has a performance-oriented flex pattern that is ultra comforting to the knees, it is incredibly dynamic, easy to control and dashing fast. The Master C+ is a pure joy to ride.

/ PERFORMANCE FEATURES

- Super lightweight performance freestyle and freeride twin tip
- 3D shaped Paulownia wood core for an outstanding flex pattern
- Spread Tow Carbon lamination for a precise and responsive ride
- Rail steps and multi channels for control and speed
- Multi-stage rocker for better pop and smooth landings
- Heavy-duty plywood block inserts
- Glossy UV resistant top deck for long lasting durability
- 45 mm G10 fins come included

/ DESIGNER QUOTE

Space grade Spread Tow Carbon boosts performance of this beauty.

Franz Schitzhofer



SIZES

136 x 41 / 139 x 42



/ RIDING Style

Freestyle / hooked	● ● ● ● ● ● ● ●
Wakestyle (unhooked)	● ● ● ● ●
Freeride	● ● ● ● ● ● ● ●
New to The Sport	● ● ●
Light Wind Race	● ● ●

/ TECH CONSTRUCTION

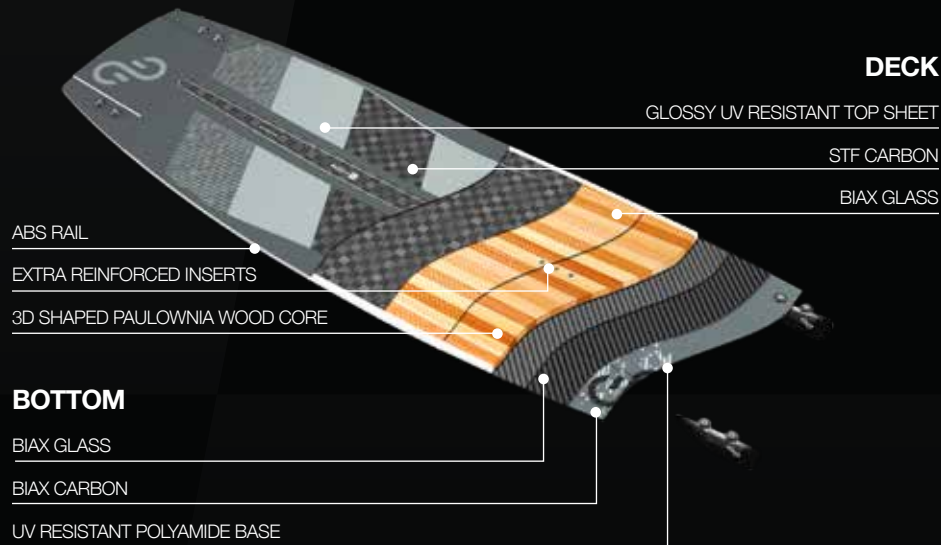

DECK

GLOSSY UV RESISTANT TOP SHEET

STF CARBON

BIAX GLASS

BOTTOM

BIAX GLASS

BIAX CARBON

UV RESISTANT POLYAMIDE BASE

LENGTH	WIDTH	RIDER WEIGHT	FINS	BOARD WEIGH IN KG
136	41	55-80 KG	G10 fins / 45mm	2.4
139	42	65-90 KG	G10 fins / 45mm	2.5

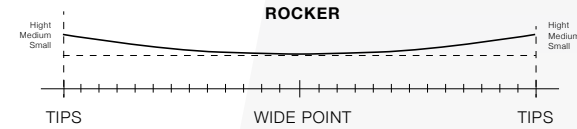

ROCKER

- Multi stage rocker
- Increased grip and pop
- Great upwind performance and early planing



FLEX

- Medium flex through center and tips
- Optimized flex patterns for each size
- Eats the chop
- Harder reverse flex and reduced torsional flex

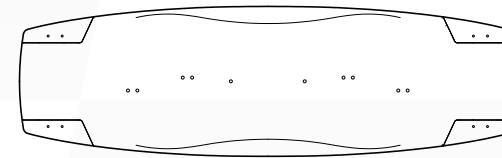

OUTLINE

- Elliptic outline with rounded tips
- Great carving ability
- Smooth ride design
- High Impact box rail for better grip and durability



BOTTOM SHAPE

- Double concave with rail steps
- Deep tip channels for more pop
- Rail steps for more grip and upwind ability

COMMANDER

PERFORMANCE FREESTYLE



Rider: Arthur Guillebert
Picture: Samuel Cardenas

COMMANDER

PERFORMANCE FREESTYLE



SIZES

137 x 41.5 / 141 x 42.5

/ DESIGN VISION

Our entirely new board, the Commander, is the flagship of our commitment to freestyle riding. Every inch of this ultra-durable construction is perfected to shred hard and pump out handle pass tricks. It also rules when it is ridden in storms for big airs. The combination of A-grade Paulownia wood and a layer of Triax Carbon Composite provides the stiffness and control to hold the edge no matter the load. Once released the flex catapults the rider out of the water with an enormous pop. The elaborate Tri-channel design allows the rider to hit the water even without the included 30 mm G10 fins as they already offer plenty of grip. Its performance, though fierce, is easy to access, so popping this board comes naturally even for those who are just starting with freestyle tricks. The Commander is shaped to rule any spot.

/ PERFORMANCE FEATURES

- High-performance freestyle twin tip
- 3D shaped Paulownia wood core for an outstanding flex pattern
- Triax Carbon Composite for torsional stiffness and accessible performance
- Medium to hard flex for direct board control
- Carbon reinforcements for a harder reverse flex
- Tri-channel tip design for ultimate grip
- Glossy UV resistant top deck for long lasting durability
- 30 mm G10 fins come included

/ DESIGNER QUOTE

This stick is made to stomp it. The Commander elevates your skills and boosts your performance to the next level!

Franz Schitzhofer



COMMANDER

PERFORMANCE FREESTYLE

/ RIDING Style

Freestyle / hooked	● ● ● ● ●
Wakestyle (unhooked)	● ● ● ● ● ●
Freeride	● ● ● ●
New to The Sport	●
Light Wind Race	● ●

/ TECH CONSTRUCTION

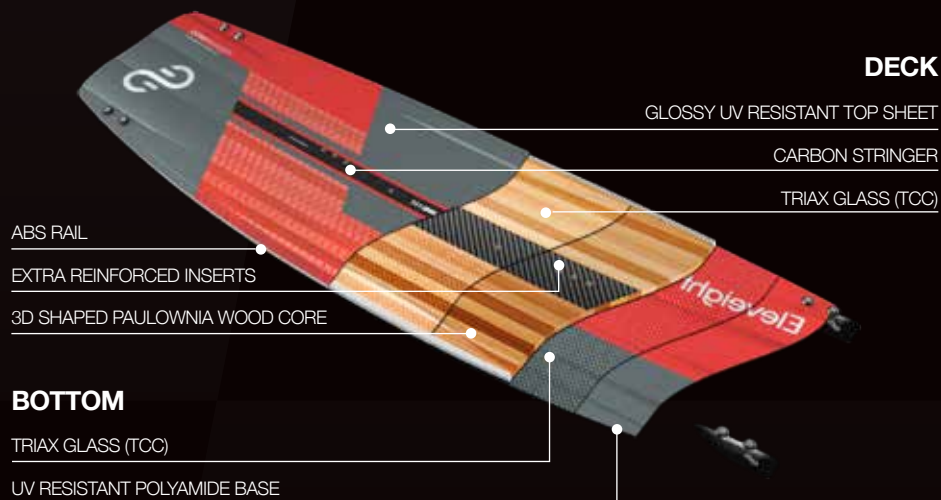

LENGTH	WIDTH	RIDER WEIGHT	FINS	BOARD WEIGH IN KG
137	41.5	>85kg	G10 fins / 30mm	2.85
141	42.5	75+ kg	G10 fins / 30mm	2.95

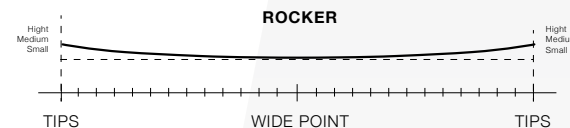

ROCKER

- Multi Stage Rocker
- Incredible pop and grip
- Great upwind performance and early planing



FLEX

- Medium to hard flex for explosive pop
- Optimized flex patterns for each size
- Harder reverse flex for controlled landings
- Reduced torsional flex for direct board control

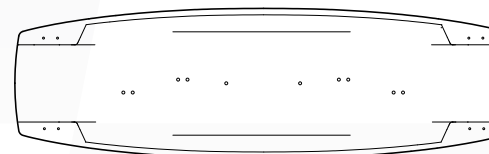

OUTLINE

- Elliptic outline with rounded tips
- Great carving ability
- Dynamic ride design
- 3D box rails for better grip and durability



BOTTOM SHAPE

- Multi channel design with rail steps
- Tri channel tip design for ultimate grip
- Railsteps for better upwind ability
- Torsion box with flat center

TWINTIP FINDER



IGNITION /
Progression Freeride

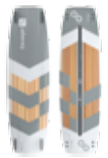

PROCESS /
Performance Freeride



MASTER C+ /
Performance Freestyle



MASTER
Performance Freestyle



COMMANDER /
Performance Freestyle

	FREESTYLE UNHOOKED pop / wakestyle	FREESTYLE HOOKED big Air / Controlled Landings	FREERIDE Comfort / Early Planing Upwind / Carving	PROGRESSION Easy Ride / Control
IGNITION / Progression Freeride			Light Gray, Medium Gray, Dark Gray	Dark Gray
PROCESS / Performance Freeride		Light Gray	Dark Gray, Medium Gray, Light Gray	Dark Gray, Light Gray
MASTER C+ / Performance Freestyle	Light Gray, Medium Gray	Dark Gray, Medium Gray	Dark Gray, Medium Gray, Light Gray	
MASTER Performance Freestyle	Light Gray, Medium Gray	Dark Gray, Medium Gray	Dark Gray, Medium Gray, Light Gray	
COMMANDER / Performance Freestyle	Dark Gray, Medium Gray	Dark Gray, Medium Gray	Light Gray	



Eleveight boards are built with dedication, experience and the highest quality materials. Each board is shaped to perfection for superior performance and lasting durability. All boards are made in Europe.

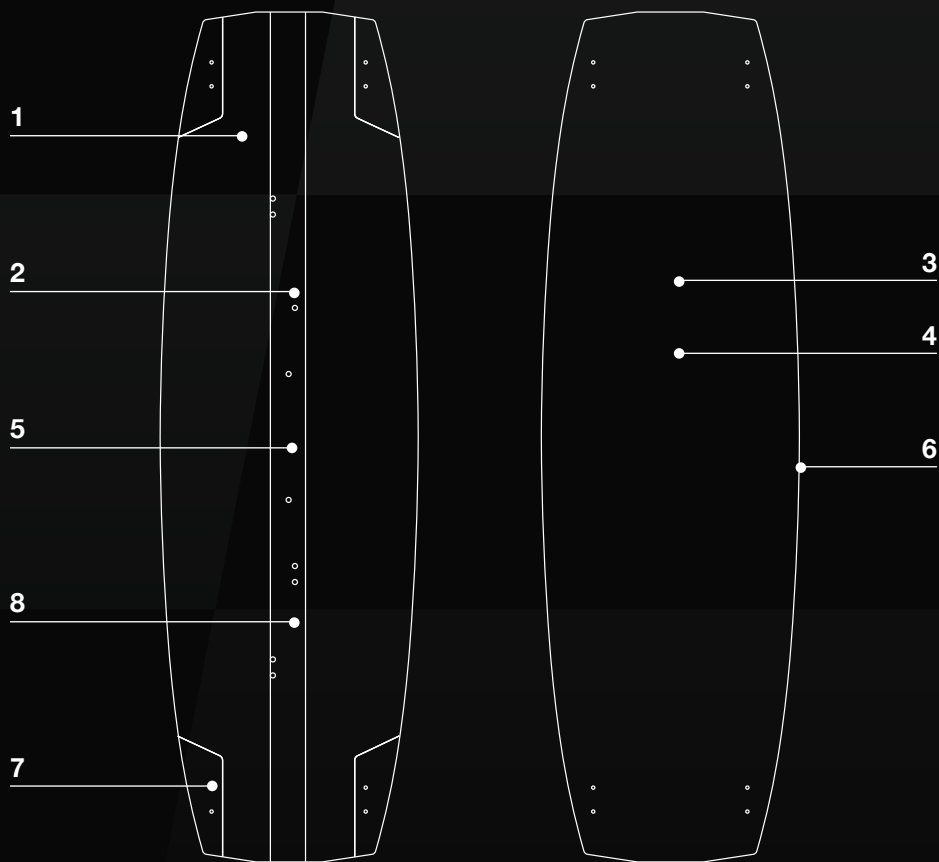

TWINTIP STRUCTURE

E/8 TRUSTED QUALITY / TWINTIPS

1 / CNC mill A-grade Paulownia wood core

Flex pattern optimized wood core

2 / Heavy duty block plywood inserts

Heavy duty block plywood inserts that allow you do choose between straps and boots. Inserts don't get stronger than this.

3 / UV resistant top base

To ensure that your board will keep its good look, it comes with a UV resistant top base.

4 / Biax laminat

The high quality fibres of our biax laminat contribute to the flex pattern and amazing pop characteristics.

5 / Carbon reinforcements

Extra strong Carbon layer (330g)

6 / ABS rails

The box rails deliver an outstanding grip while protecting the board from wear and tear.

7 / G10 fins

These high quality epoxy fins deliver the stiffness you need to always stay in control.

8 / Ergonomic designed pads and straps

These pads cling to your feet, providing a maximum of control. Furthermore they are most comfortable, cushioning bumpy rides and hard landings.

CURL

PERFORMANCE
SURFBOARD



Rider: Kelton Almeida
Picture: Gabriele Rumbolo

CURL

PERFORMANCE
SURFBOARD

CVC
Composite Vacuum
Sandwich Construction



SIZES

5'7 x 17 5/8 x 2 - 23 Ltr
5'10 x 19 x 2 1/4 - 26.5 Ltr

/ DESIGN VISION

We designed the Curl for ambitious surfers that need performance to be at their feet when tackling the surf. It is great in all conditions, from weak and blown out wind swells to barreling reef slabs. Explosive hacks are coming naturally to those riding this board. The magic lies within the state of the art composite vacuum sandwich construction that is lightweight and extra durable, featuring a tough bamboo top deck and a full carbon bottom. A single concave at the bottom, thin rails, a medium rocker line, and a squash tail provide the outstanding surf characteristics. Ride the Curl and throw some serious spray.

/ PERFORMANCE FEATURES

- Modern shortboard for rapid turns
- CVC construction that is lightweight and ultra-durable
- Bamboo top deck that is strong and impact resistant
- Single concave bottom to generate speed and dynamic drive
- Medium rocker line for explosive hacks and full control
- Thruster fin set-up with Futures system
- High-density EVA pads for perfect grip
- Ideal for riding medium to big sized waves

/ DESIGNER QUOTE

The Curl combines a professional surf shape with outstanding materials and craftsmanship. It is meant to rip in all conditions.

Peter Stiewe





/ TECH CONSTRUCTION

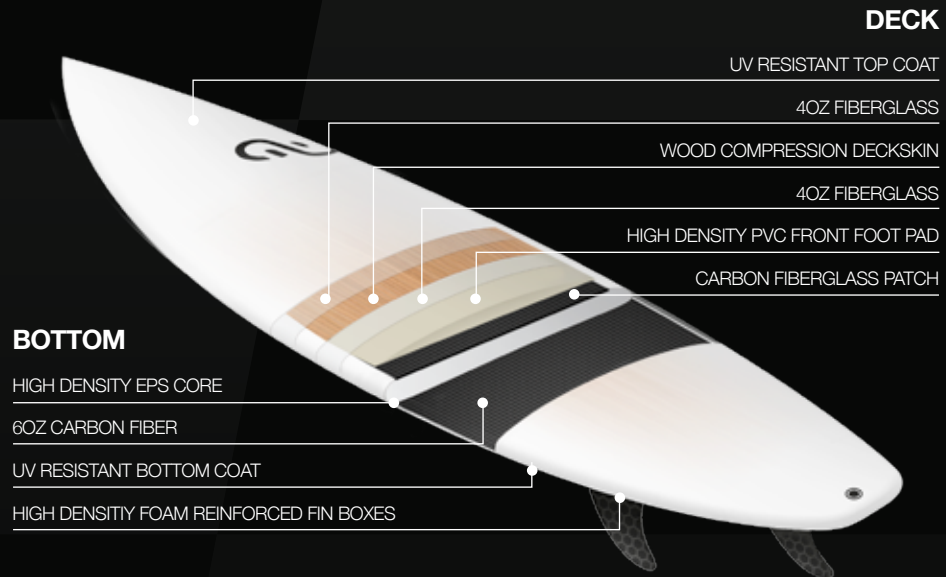

DIMENSION	VOLUME	RIDER WEIGHT	FUTURES FIN BOX	BOARD WEIGH IN KG
5'7 x 17 5/8 x 2	23 Ltr	60 -85 kg	HPF / MED THRUSTER	2.8*
5'10 x 19 x 2 1/4*	26.5 Ltr	75 - 90+	HPF / MED THRUSTER	3*

* board only
* includes foot strap inserts

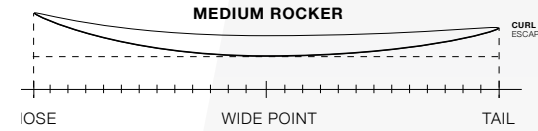

ROCKER

- Medium Rocker
- Perfect lift/drag ratio for enhanced control in steep waves
- Tight turning radius

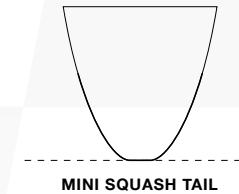

TAIL

- Mini Squash Tail
- Well balanced for sharp snaps and carving turns
- Quick rail to rail transitions



RAILS

- Thin Rail Profile
- Good rail control in bottom and top turns
- Perfect grip in fast and bigger surf

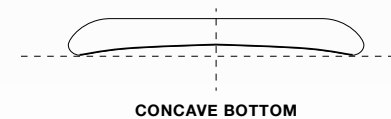

BOTTOM SHAPE

- Single Concave
- Added grip for riding down steep faces and carving hard turns
- Speed and drive through turns and flats



FREESTYLE
SURFBOARD



Rider: Rafael Madueno Morales
Picture: Samuel Flotat



**FREESTYLE
SURFBOARD**

CVC
Composite Vacuum
Sandwich Construction



SIZES

5'1 x 17 5/8 x 2 1/16 - 21.5 Ltr

5'4 x 18 1/2 x 2 3/16 - 25.5Ltr

/ DESIGN VISION

The Escape is the best choice for strapless freestyle riders that seek an extra-durable, yet performance-oriented board. It is made in an exceptional process following highest construction standards. The board features a composite vacuum sandwich construction that includes a full Bamboo top deck and a full carbon layer on the bottom. This combination is very light and insanely tough. The noseless design with short rail lines provides plenty of grip, is optimized for popping out of the water and initiating rotations. The Escape also performs in small to mid-sized waves as it has the direct feel which is needed for long carves and snappy hacks. Unleash the Escape and rule the sea.

/ PERFORMANCE FEATURES

- Versatile noseless shape for strapless freestyle
- CVC construction that is lightweight and extra durable
- Bamboo top deck that is strong and impact resistant
- Moderate rocker line for speed and early planing
- Short rail line to minimize drag and optimize pop
- Thruster fin set-up with Futures system
- High-density EVA pads for perfect grip
- Ideal for strapless freestyle and small to medium waves

/ DESIGNER QUOTE

The Escape is state of the art in material and lightweight construction. It will increase your strapless freestyle performance and give you the confidence to go for the hardest tricks in all possible conditions.

Peter Stiewe





**FREESTYLE
SURFBOARD**

CVC
Composite Vacuum
Sandwich Construction



/ TECH CONSTRUCTION

DECK

UV RESISTANT TOP COAT

4OZ FIBERGLASS

WOOD COMPRESSION DECKSKIN

4OZ FIBERGLASS

HIGH DENSITY PVC FRONT FOOT PAD

CARBON FIBERGLASS PATCH

BOTTOM

HIGH DENSITY EPS CORE

6OZ CARBON FIBER

UV RESISTANT BOTTOM COAT

HIGH DENSITY FOAM REINFORCED FIN BOXES

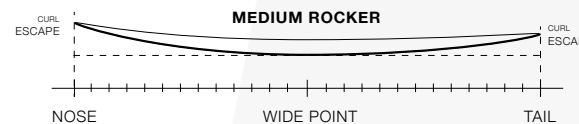

ROCKER

- Low Rocker
- Provides early planing and speed in fast sections and flats
- Perfect for small waves of all types and strapless freestyle

TAIL

- Wide Squash Tail with Small Wingers
- Responsive feel for sharp and tight turns
- Easy to pop and airborne characteristics

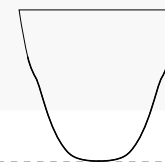

WIDE SQUASH TAIL WITH SMALL WINGERS

RAILS

- Thin Rail Profile
- Great rail control in bottom and top turns
- Perfect grip even at take offs and landings in choppy water



THIN RAIL PROFILE

BOTTOM SHAPE

- Single Concave with Channels
- Channels on nose and tail provide more waterflow to generate drive and speed
- The shape enhances the responsiveness and adds grip for technical tricks



CONCAVE BOTTOM WITH CHANNELS

DIMENSION	VOLUME	RIDER WEIGHT	FUTURES FIN BOX	BOARD WEIGH IN KG
5'1 x 17 5/8 x 2 1/16	21.5 Ltr	> 80kg	HPF / MED THRUSTER	2.7*
5'4 x 18 1/2 x 2 3/16	25.5 Ltr	75 - 90+	HPF / MED THRUSTER	2.8*

* board only



Eleveight boards are build with dedication, experience and highest quality materials. Each board is shaped to perfection for highest performance and lasting durability.

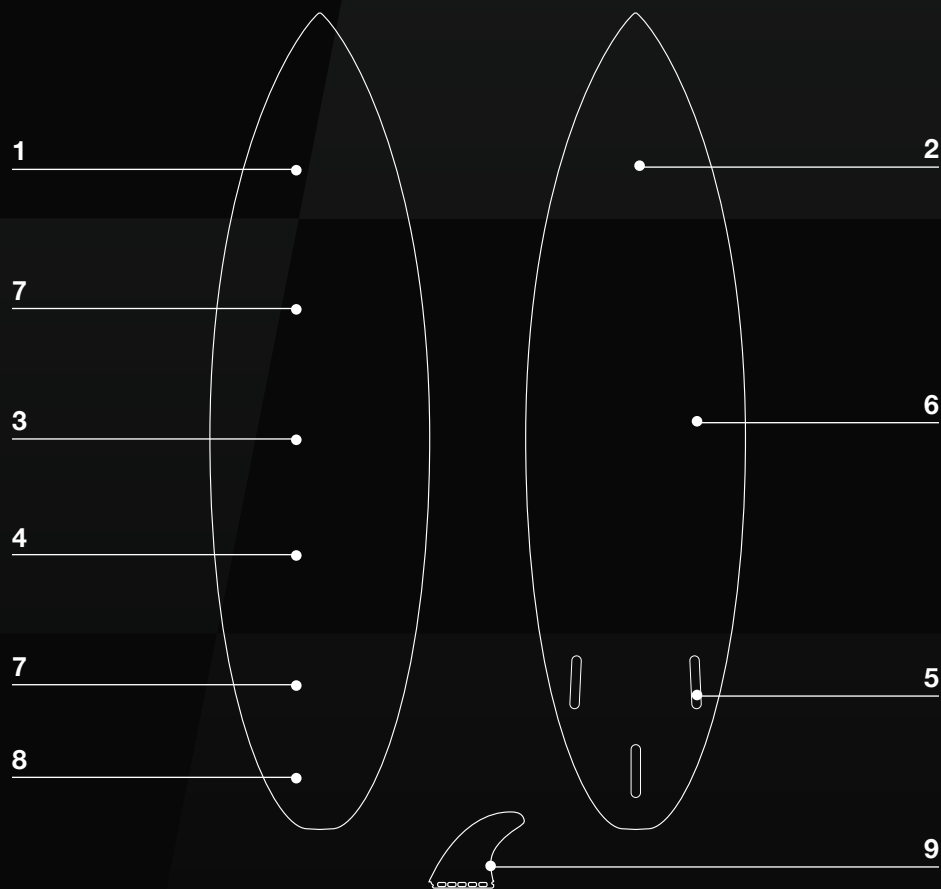

SURFBOARD STRUCTURE

E/8 TRUSTED QUALITY / SURFBOARDS

1 / HIGH DENSITY EPS CORE

Super light EPS foam core with long lasting durability.

2 / COMPOSITE VACUUM SANDWICH CONSTRUCTION (CVC)

The progressive CVC construction allows us to shape the lightest, yet most durable boards.

3 / WOOD COMPRESSION DECKSKIN

A light Bamboo layer creates a shook-proof resistant stance area to absorb almost any impact.

4 / HIGH DENSITY PVC FOAM

The front foot area is reinforced with PVC foam to enhances the board's durability at points of high stress.

5 / REINFORCED FUTURES FIN BOX

The board comes with the proven Futures fin system, which we integrated using extra-strong PVC foam for longevity.

6 / FULL CARBON LAYER ON BOTTOM

The 6 oz carbon layer on the bottom generates the ideal balance of flex and stiffness.

7 / EVA TAIL AND FRONT PAD

Kite-specific high-density EVA foam pads ensure slip-proof grip and high riding comfort.

8 / CARBON TAIL PATCH

The back foot area is reinforced with a strong carbon patch to protect the tail from heel pressure and ensure longevity.

9 / HPF THRUSTER FINNS

The HPF thruster set-up is designed for fast, high performance kitesurfing, guaranteeing a unique blend of speed, drive, and release.



**PERFORMANCE
SURFBOARD**

CFT
Carbon Flex
Technology



SIZES

5'7 x 17 5/8 x 2 - 23 Ltr
5'10 x 19 x 2 1/4 - 26.5 Ltr

/ DESIGN VISION

The Curl Pro is based on the shape of proven performance surfboards and was adapted and optimized for kite-powered riding. The smart CFT construction with an integrated Innegra/carbon vector grid and carbon stringer delivers the distinctive flex and surf feel while being tough and sturdy. A single bottom concave and squash tail make this board extremely fast and dynamic, perfect for snappy cutbacks and smooth carves. The board is hand shaped in Portugal and a great choice for smaller days. However, it is absolutely incredible in punchy mid to large sized waves. It is addressed to ambitious strapless riders with the need for unlimited performance in all conditions. Ride the Curl and the lineup is yours.

/ PERFORMANCE FEATURES

- Performance shortboard for quick turns
- CFT construction that generates a pure surf feel
- Carbon stringer for responsive flex and durability
- Single concave bottom to generate speed and dynamic drive
- Innegra/carbon vector grid reinforcements for enhanced durability
- Thruster fin set-up with Futures system
- High-performance board shaped by hand (no inserts for straps)
- Ideal for riding medium to big sized waves

/ DESIGNER QUOTE

The Curl Pro is hand shaped in Portugal using our innovative CFT construction. It delivers the distinctive surf feel and buoyancy of a true surfboard. We optimized the construction for kite-powered riding.

Team Eleveight





PERFORMANCE
SURFBOARD

CFT
Carbon Flex
Technology



/ TECH CONSTRUCTION

DECK

4OZ FIBERGLASS

3 STEP CARBON STRINGER

INEGRA/CARBON VECTOR REINFORCEMENT

4OZ FIBERGLASS PATCH

5OZ BIAXIAL FIBERGLASS LAYER

PU FOAM WITH WOOD STRINGER

BOTTOM

3 STEP CARBON STRINGER

6OZ FIBERGLASS

INEGRA/CARBON VECTOR REINFORCEMENT

HIGH DENSITY FOAM REINFORCED FIN BOXES

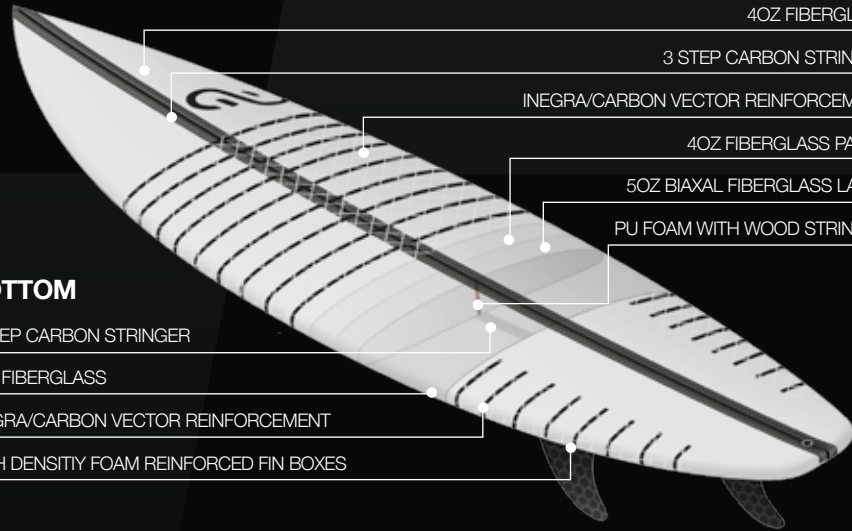

DIMENSION	VOLUME	RIDER WEIGHT	FUTURES FIN BOX	BOARD WEIGH IN KG
5'7 x 17 5/8 x 2	23 Ltr	60 -85 kg	HPF / MED THRUSTER	2.7
5'10 x 19 x 2 1/4	26.5 Ltr	75 - 90+	HPF / MED THRUSTER	2.85

* board only

/ CHANGES for 2020

- New carbon stringer for better flex
- A new color of the surfboard blanks
- Reinforced fin boxes for enhanced longevity
- Additional top of biaxial fibreglass for increased durability

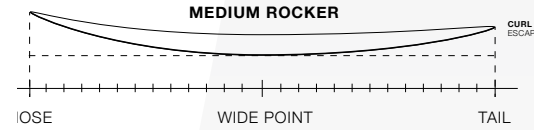

ROCKER

- Medium Rocker
- Perfect lift/drag ratio for enhanced control in steep waves
- Tight turning radius

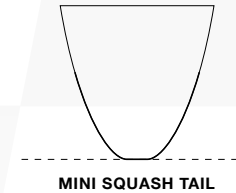

TAIL

- Mini Squash Tail
- Well balanced for sharp snaps and carving turns
- Quick rail to rail transitions



RAIL

- Thin Rail Profile
- Good rail control in bottom and top turns
- Perfect grip in fast and bigger surf

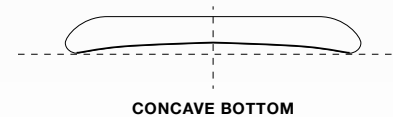

BOTTOM SHAPE

- Single Concave
- Added grip for riding down steep faces and carving hard turns
- Speed and drive through turns and flats



**FREESTYLE
SURFBOARD**

CFT
Carbon Flex
Technology



SIZES

4'11 x 17 1/2 x 2 - 20 Ltr
5'1 x 17 5/8 x 2 1/16 - 21.5 Ltr
5'4 x 18 1/2 x 2 3/16 - 25.5Ltr

/ DESIGN VISION

The Escape Pro is a fierce strapless board handmade in Portugal, optimized for freestyle and wave riding. Its progressive noseless shape with short rails is based on a premium medium density PU-core, and comes encased by innovative tech-materials. The extraordinary CFT construction maximizes the board's flex and feedback, generating the distinctive surf-feel of a professional board. A carbon stringer and an Innegra/carbon vector grip enhance the durability by keeping a responsive flex. It is the perfect board to stomp strapless freestyle tricks or throw some serious spray on small to medium sized waves. Escape your limitations and unleash your potential.

/ PERFORMANCE FEATURES

- Progressive no-nose shape for strapless freestyle and surf
- CFT construction that generates a pure surf feel
- Carbon stringer for responsive flex and durability
- Innegra/carbon vector grid reinforcements for enhanced durability
- Short rail line to minimize drag and faster rotations
- Thruster fin set-up with Futures system
- High-performance board shaped by hand (no inserts for straps)
- Ideal for strapless freestyle and small to medium waves

/ DESIGNER QUOTE

The Escape Pro is hand made with our innovative CFT construction. It offers a responsive flex with great pop and lift, while it still has a dam good surf feel.

Team Eleveight





**FREESTYLE
SURFBOARD**

CFT
Carbon Flex
Technology



/ TECH CONSTRUCTION

DECK

4OZ FIBERGLASS

3 STEP CARBON STRINGER

INEGRA/CARBON VECTOR REINFORCEMENT

4OZ FIBERGLASS PATCH

5OZ BIAXAL FIBERGLASS LAYER

PU FOAM WITH WOOD STRINGER

BOTTOM

3 STEP CARBON STRINGER

5OZ BIAXAL FIBERGLASS LAYER

4OZ FIBERGLASS

INEGRA/CARBON VECTOR REINFORCEMENT

HIGH DENSITY FOAM REINFORCED FIN BOXES

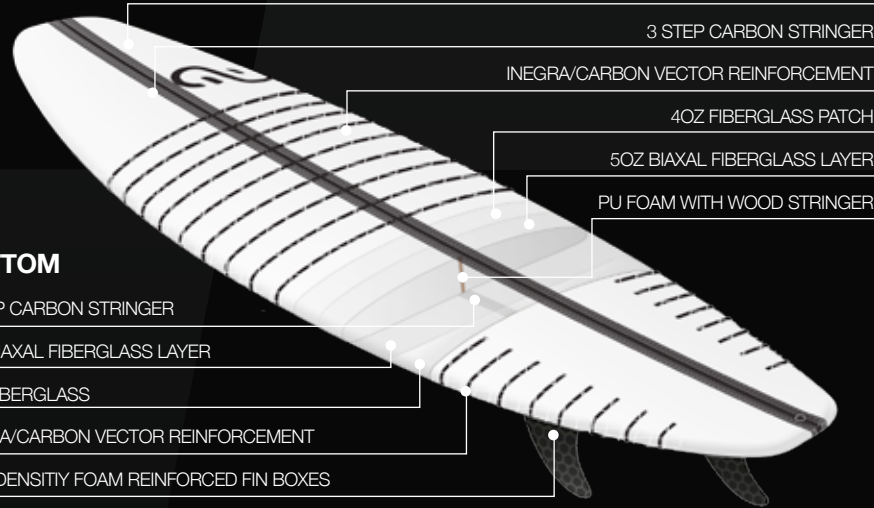

DIMENSION	VOLUME	RIDER WEIGHT	FUTURES FIN BOX	BOARD WEIGH IN KG
4'11 x 17 1/2 x 2	20 Ltr	> 70kg	HPF / MED THRUSTER	2.8
5'1 x 17 5/8 x 2 1/16	21.5 Ltr	65 - 80 kg	HPF / MED THRUSTER	2.9
5'4 x 18 1/2 x 2 3/16	25.5 Ltr	75 - 90+	HPF / MED THRUSTER	3

* board only

/ CHANGES for 2020

- New carbon stringer for better flex
- Additional top of biaxial fibreglass for increased durability
- A new color of the surfboard blanks
- Reinforced fin boxes for enhanced longevity
- Redefined rail, optimized for grab tricks

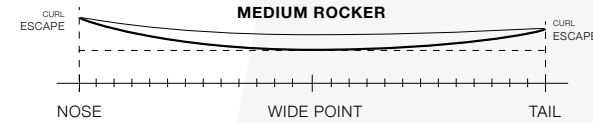

ROCKER

- Low Rocker
- Provides early planing and speed in fast sections and flats
- Perfect for small waves of all types and strapless freestyle

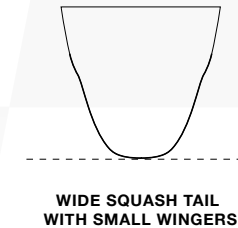

TAIL

- Wide Squash Tail with Small Wingers
- Responsive feel for sharp and tight turns
- Easy to pop and airborne characteristics



RAIL

- Thin Rail Profile
- Great rail control in bottom and top turns
- Perfect grip even at take offs and landings in choppy water

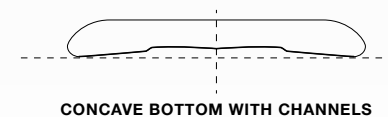

BOTTOM SHAPE

- Single Concave with Channels
- Channels on nose and tail provide more waterflow to generate drive and speed
- The shape enhances the responsiveness and adds grip for technical tricks

Eleveight boards are built with dedication, experience and the highest quality materials. Each board is shaped to perfection for superior performance and lasting durability. All boards are made in Europe.

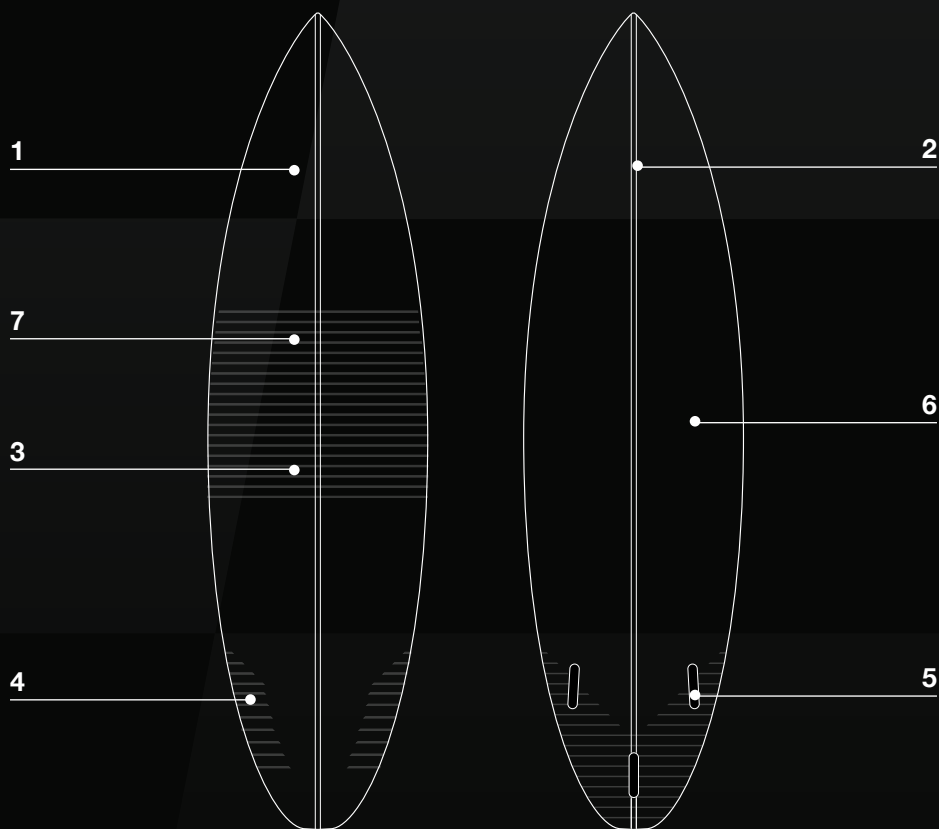

E/8 TRUSTED QUALITY / SURFBOARDS

1 / MEDIUM DENSITY PU FOAM

Our Polyurethane Blank (PU) foam is not only strong but also super light - it ensures optimal board feel and creates the perfect buoyancy.

2 / CARBON FLEX TECHNOLOGY (CFT)

The CFT construction combines the highest quality materials for the perfect mix of control, comfort and board feedback. The integrated carbon stringer enhances the board's flex even further.

3 / INEGRA/CARBON VECTOR GRID FRONT FOOT

Regular surfboards easily dent or snap in hard landings or wipe-outs. Our strong Inegra/Carbon Vector Grid tremendously enhances the board's durability at points of high stress.

4 / INEGRA/CARBON VECTOR GRID TAIL

The board's tail is often a victim to abuse or even unwanted contact with beaches or rock. To increase its durability we strengthened it with our Inegra/Carbon Vector Grid.

5 / REINFORCED FUTURES FIN BOX

The board comes with the proven Futures fin system, which we integrated using extra-strong PVC foam for longevity.

6 / HANDSHAPEDS

After the CNC machine provides the perfect blank Portugal's most experienced shapers take over. With an eye for detail they shape and glass each board to perfection.

7 / EXTRA REINFORCEMENTS

Full layer of 160g Biaxal fiberglass to reinforce the top deck + 4oz front foot patch

SURF FINDER



	STRAPLESS FREESTYLE		SMALL	SURF MEDIUM		BIG
Escape / Freestyle surfboard						
Escape Pro / Freestyle surfboard						
Curl / Performance surfboard						
Curl Pro / Performance surfboard						

HCS

PERFORMANCE FREERIDE



Rider: David Tonijuan Colomer
Picture: Nico Pelaez Linden

HCS

PERFORMANCE FREERIDE

/ DESIGN Vision

Control meets versatility meets speed. Our brand new HCS carving foil redefines hydrofoil performance. It is extremely user-friendly as it offers great lift and extraordinary stability. Swift carves and reaching racing speed is a breeze riding this wing. To achieve these characteristics we combined an 85 cm aerospace grade aluminum mast with a carbon composite front wing and a G10 back wing. This setup also results in ultimate control and dynamic maneuverability. The modular construction with an interchangeable mast comes with lasting durability. Hydrofoil experts, as well as progressing riders, will enjoy every take-off with this incredible wing.

/ PERFORMANCE Features

- Performance Freeride Foil
- Made for versatile usage, ultimate control and dynamic maneuverability
- Medium aspect front wing for great lift and stability
- 85 cm mast
- Carbon composite front wing with top mounting
- Quick connect technology
- Durable G10 Stabilizer
- Includes travel bag

FRONT WING: 860 cm²
MAST: 85 CM



HCS

PERFORMANCE FREERIDE

/ RIDING Style

Freeride	●	●	●	●	●	●
Race	●	●	●			
Surf	●	●	●	●		
Lightwind	●	●	●	●	●	
Accessibility	●	●	●	●	●	

/ DESIGNER Quote

The HCS is designed for an accessible performance with a focus on dynamic carving. The foil design is well balanced, and we paid special attention to durability.

Team Eleveight

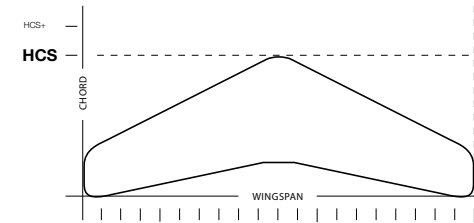

FRONT WING

FRONT WING

- Light carbon composite construction
- Medium aspect wing for easy lift and glide
- Projected surface area: 860 cm²
- Wingspan 65cm

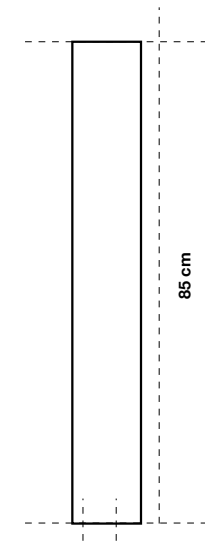

MAST

MAST

- Anodized aero grade alloy construction
- Optimal ratio between strength and weight
- Size: 85cm

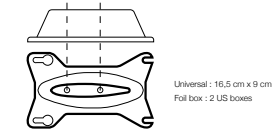

PLATE

PLATE

- CNC precision cut anodised alloy
- Strong and fast attachment system
- Marine grade stainless steel hardware

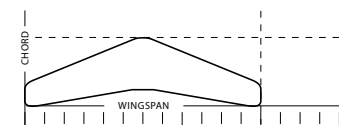

STABILIZER

STABILIZER

- Durable G10 composite construction
- Versatile with great overall directional stability
- Projected surface Area: 240 cm²
- Wingspan 39 cm

HCS+

PROGRESSION FREERIDE

/ DESIGN Vision

Our brand new HCS+ hydrofoil makes foiling accessible to everyone. The 60 cm mast with a top-mounted carbon composite front wing and G10 stabilizer offers incredible control for swift progression. This rapid progression does not come at the price of performance loss. If anything, the HCS+ slits through water in staggering speed, providing a maximum of maneuverability. We recommend this wing to anybody looking to get started with foiling as well as for schools, as the construction is ultra durable and success comes on the fly.

/ PERFORMANCE Features

- Progressive Freeride foil
- Accessible wing design suitable for all levels
- Front wing with medium to low aspect ratio for intuitive performance
- 60 cm mast
- Carbon composite front wing with top mounting
- Quick connect technology
- Durable G10 Stabilizer
- Includes travel bag

FRONT WING: 1220 cm²
MAST: 60 CM



HCS+

PROGRESSION FREERIDE

/ RIDING Style

Freeride	●	●	●	●	●
Race	●	●			
Surf	●	●	●	●	●
Lightwind	●	●	●	●	●
Accessibility	●	●	●	●	●

/ DESIGNER Quote

We designed the HCS+ to accelerate your foiling progression in the safest way possible.

Team Eleveight

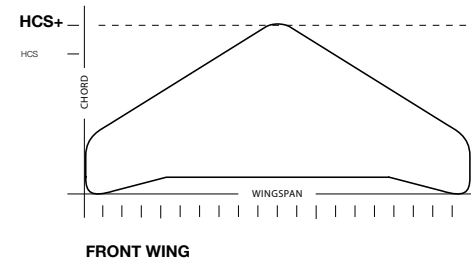

FRONT WING

- Light carbon composite construction
- Medium to low aspect wing for easy lift and glide
- Projected surface Area: 1220 cm²
- Wingspan 65cm

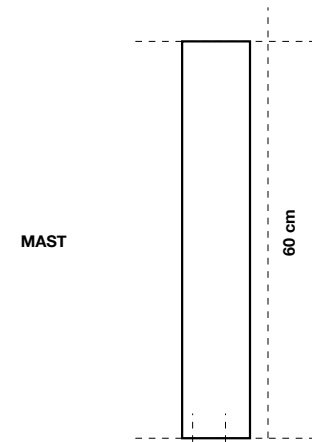

MAST

- Anodized aero grade alloy construction
- Optimal ratio between strength and weight
- Size: 60cm

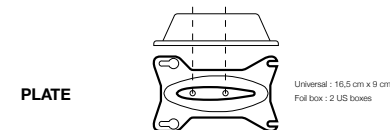

PLATE

- CNC precision cut anodised alloy
- Strong and fast attachment system
- Marine grade stainless steel hard ware

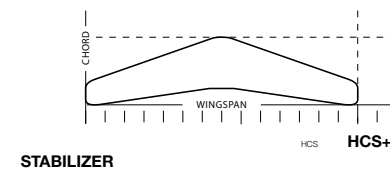

STABILIZER

- Durable G10 composite construction
- Versatile with great overall directional stability
- Projected surface Area: 280 cm²
- Wingspan 44 cm



Eleveight's foil design is based on the latest in aerodynamic science. Precise manufacturing of premium materials results in a foil that effortlessly cuts through the water while generating outstanding lift.

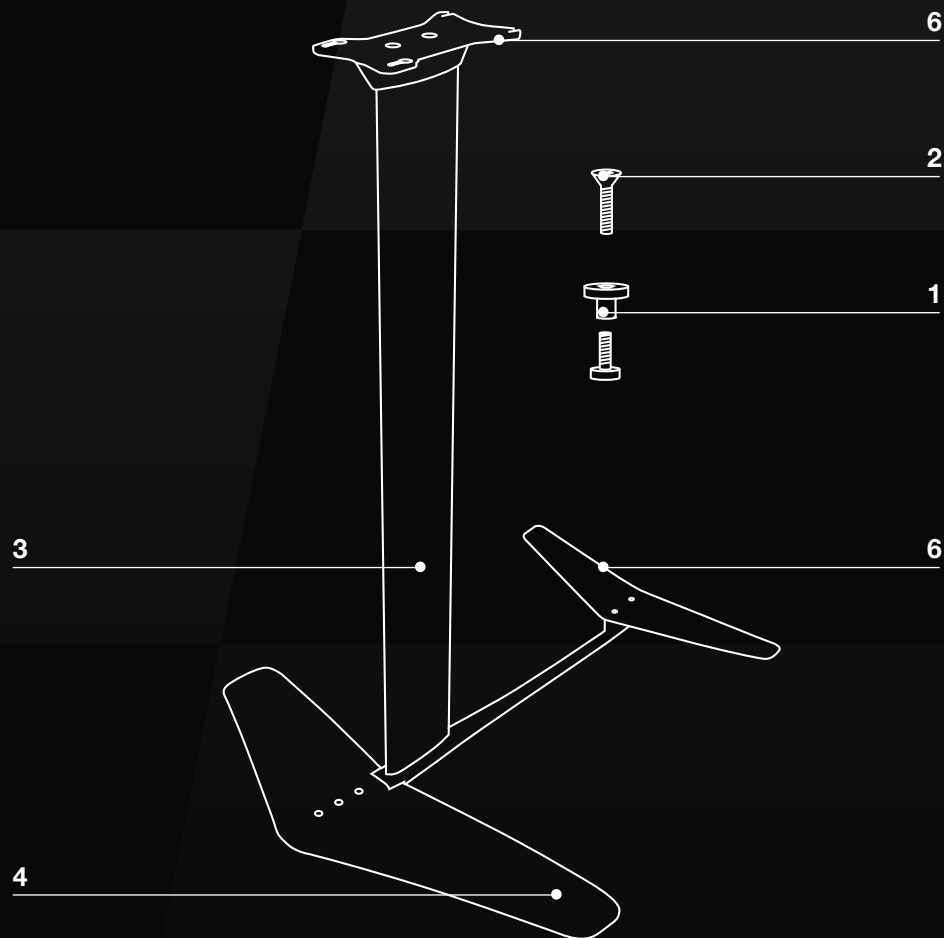

FOIL STRUCTURE

E/8 TRUSTED QUALITY / FOIL

1 / Marine grade stainless steel hardware We use 316 Marine grade stainless steel to ensure a strong connection between all foil components and between board and mast, that is also durable thanks to its resistance to corrosive saltwater.

2 / Torx screws All screws come with Torx heads in order to sustain the screws longer.

3 / Anodized aero grade alloy We use an anodized aero grade alloy to provide a lighter, corrosive-resistant construction that is also durable.

4 / Carbon reinforced front wing Strategically placed carbon reinforcements prevent torsional flex while being ultra light.

5 / G10 stabilizer The high-quality epoxy construction of the stabilizer delivers the stiffness you need to always stay in full control.

6 / Quick connect Our quick and firm attachment system allows you to swap or reposition your foil within seconds.

CARVAIR

PERFORMANCE FREERIDE



Rider: David Tonijuan Colomer
Picture: Nico Pelaez Linden

CARVAIR

PERFORMANCE FREERIDE

/ DESIGN Vision

The Carvair is the ultimate control station for our HCS and HCS+ foil wings. This board is made to carve, hence we came up with an innovative rail design that prevents catching waters in tight turns. Its low volume carbon composite construction guarantees a smooth and easy ride while offering maximum performance with a direct power transfer. A double density deck pad prevents injuries and provides a soft but sure stance. The Carvair is the perfect choice for progressing riders as well as experts.

/ PERFORMANCE Features

- Freeride foil board for versatile riding
- Low volume for easy handling
- Light, durable and stiff carbon composite construction with direct board feedback
- Chamfering rail design for less water catching when carving
- Double density deck pad for exceptional comfort and injury prevention
- 4 x 4 track mount system with adjustable foil positioning
- Inserts for different foot strap options

SIZE: 4'3



CARVAIR

PERFORMANCE FREERIDE

/ RIDING Style

Freeride	●	●	●	●	●	●
Race	●	●				
Surf	●	●	●	●		
Lightwind	●	●	●	●	●	
Accessibility	●	●	●	●	●	●

/ DESIGNER Quote

The Carvair was designed as an all-round board with a very durable construction which helps the riders to progress in foiling.

Team Eleveight

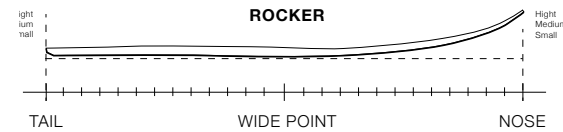

ROCKER

- Substantial nose rocker for easy control in take off and touch down situations
- Flat tail rocker for more surface area and early planing

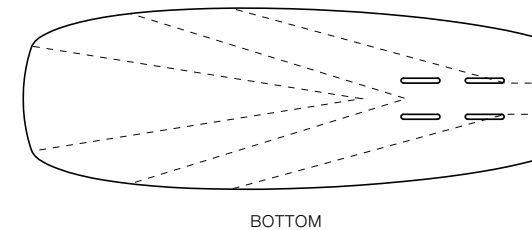

BOTTOM SHAPE/TORSION

- Unidirectional carbon construction for zero flex and direct board feedback
- V channel construction for perfect transfer of lift and torsion control
- 4 x 4 track mount System with adjustable foil positioning



RAIL

- Chamfer rail design for less water catch when carving
- ABS rails Construction for enhanced durability
- Low volume rails for easy handling



Our foil boards are magic carpets, made to fly. In order to make this magic happen, we source superior materials and shape them in a progressive manufacturing process.

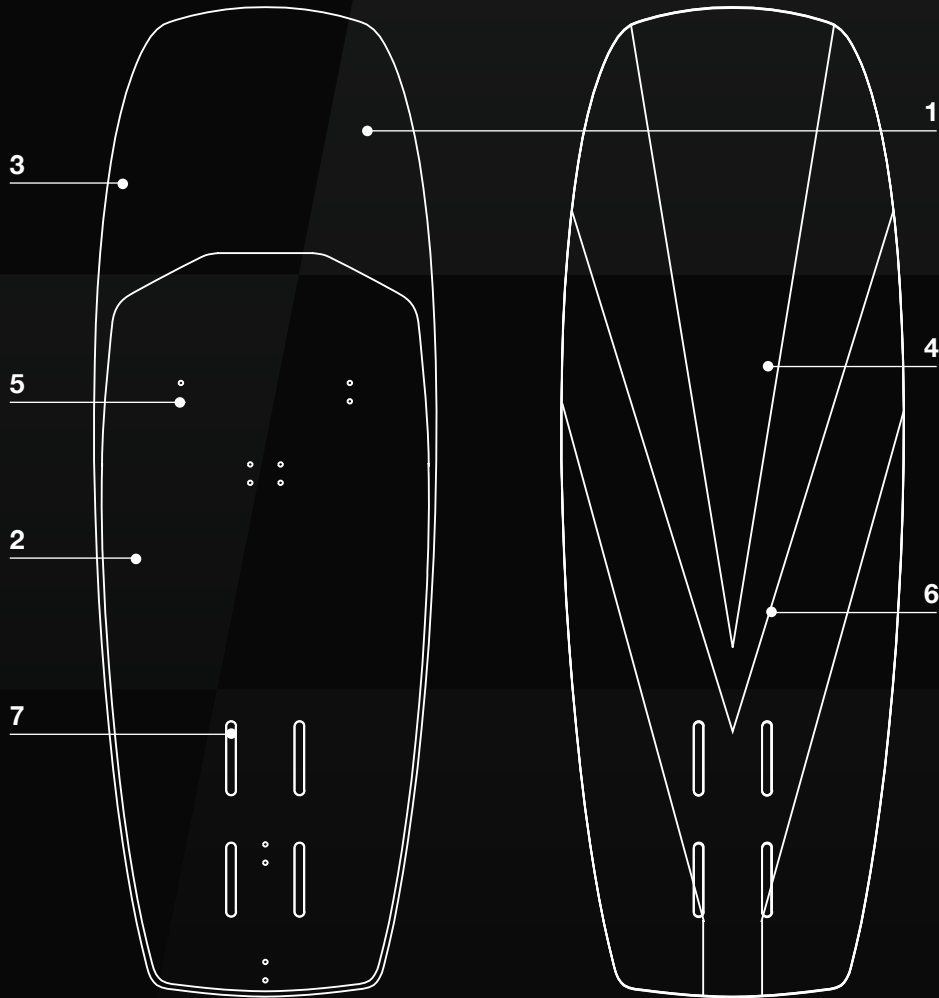

FOIL BOAR STRUCTURE

E/8 TRUSTED QUALITY / CARVAIR

1 / CNC milled A-grade Paulownia wood core The Paulownia wood core delivers stiff and responsive board feedback and comes with outstanding longevity.

2 / Full deck pad made of EVA Kite-specific high-density EVA foam ensures a slip-proof grip and high riding comfort.

3 / ABS rails The sturdy box rails optimize the deck's stiffness and low rail profile. Furthermore, they protect the board from wear and tear.

4 / Biaxial and UD Carbon The feather-light biaxial and unidirectional carbon, angled at 0° and 45°, creates the board's stiff flex pattern that ensures direct board feedback.

5 / Heavy-duty inserts Reinforced boxes with inserts allow different strap set-ups. They are made to withstand hard crashes.

6 / UV and abrasion resistant bottom sheet For the highest performance and longevity, we installed an abrasion resistant base that also withstands the harsh combination of UV light and saltwater.

7 / 4 x 4 track mount system The smart 4 x 4 mounting system creates a secure connection between mast and board. It also allows adjusting the position of the foil to personal preferences.

ACCESSORIES

SURFBAORDS, TWIN TIP, PUMP



ACCESSORIES

SURFBOARDS, TWIN TIP, PUMP

HPF Fins

Med Thruster

EACCSBFF19 HPF FINS



Front Pad

Height: 525mm / width: 380mm
3-piece pad

EACCSBFP19 FRONT PAD



Tail Pad

Height: 310mm / width: 285mm
4-piece pad
power kick 26mm

EACCSBTP19 TAIL PAD



Footstraps Foilboard

Foot Strap set (3 units)
for FOILBOARD

EAFSTRAPFOIL FOOTSTRAPS FOILBOARD



Fins G10 Epoxy

EACTTFINS Twin Tip set of 4 Fins
45mm

EACCTTFINSMOSQ Twin Tip set of 4 Fins
30mm



Footstraps Airgo

EACCTIFPS Pads & straps
TT AIRGO



Footstraps Freego

EACCTTFG Pads & straps
FREE GO 2019

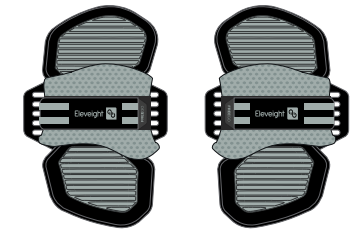

Pump

EACCP18 PUMP 2019

ACCESSORIES



ACCESSORIES

CLOTHING

HOODY

Dark Grey
 Sizes: S / M / L / XL

EPOPT20SSS	S
EPOPT20SSM	M
EPOPT20SSL	L
EPOPT20SSXL	XL
EPOPT20SSXXL	XXL



CAP

Unique Size

EPOPCAPYELLOWGREY	Trucker cap yellow & grey
EPOPCAPDARKGREY	Cap dark grey
EPOPCAPBLACKGREY	Trucker cap black & grey
EPOPCAPGREY	Cap grey



T-SHIRT

Cardinal 8
 Sizes: S / M / L / XL / XXL

EPOPT20GCLOGOS	S
EPOPT20GCLOGOM	M
EPOPT20GCLOGOL	L
EPOPT20GCLOGOXL	XL
EPOPT20GCLOGOXXL	XXL



Dark Grey 8

Sizes: S / M / L / XL / XXL

EPOPT20GDLOGOS	S
EPOPT20GDLOGOM	M
EPOPT20GDLOGOL	L
EPOPT20GDLOGOXL	XL
EPOPT20GDLOGOXXL	XXL



Dark Grey, branding

Sizes: S / M / L / XL / XXL

EPOPT20GDHTS	S
EPOPT20GDHTM	M
EPOPT20GDHTL	L
EPOPT20GDHTXL	XL
EPOPT20GDHTXXL	XXL



ACCESSORIES

FLAGS & STICKERS

Flag

Sizes: 90 cm x 60 cm

EPOPF189060 FLAG



Banner

Sizes: 160 cm x 60 cm

EPOPB1816060 BANNER

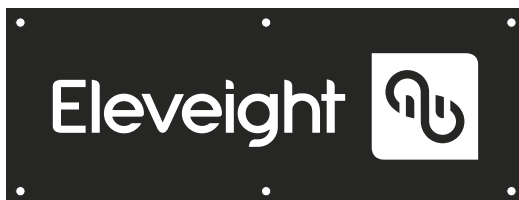

Beach Flag

Sizes: 430 cm x 80 cm

EPOPBF1843080 BEACH FLAG

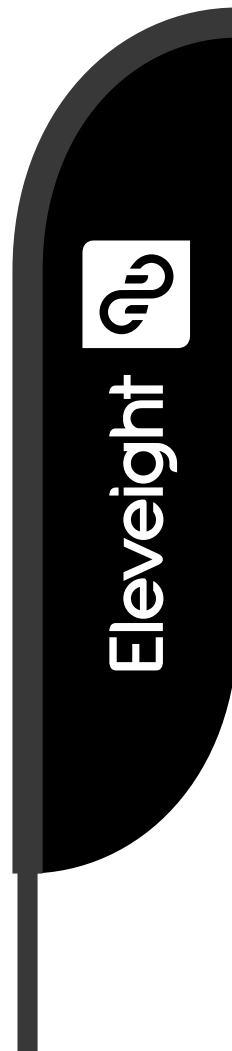

Stickers

Sizes: 80 cm x 20 cm

EPOPST188020 STICKER



Sizes: 24 cm x 24 cm

EPOPST182424 STICKER LOGO B&W



Sizes: 24 cm x 26 cm

EPOPST182426 STICKER LOGO



Sticker sheet

EPOPST188022 Sticker sheet

ACCESSORIES

TENT

INFLATABLE TENT

Sizes: High = 3.50m / 600 x 400

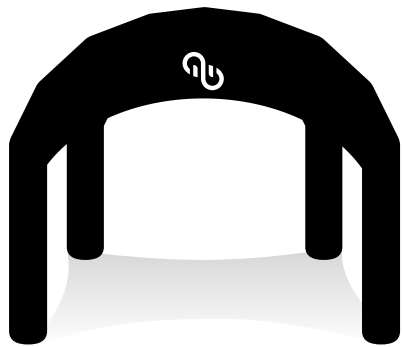

SPIDER TENT

Sizes: High = 4.50m / 600 x 600



E/8 TRUSTED QUALITY

Eleveight 



TRUSTED QUALITY

Eleveight boards are built with dedication, experience and the highest quality materials. Each board is shaped to perfection for superior performance and lasting durability. All boards are made in Europe.

eleveightkites.com/e8-trusted-quality



EXTENDED WARRANTY

Eleveight stands behind all of its products! We offer an extended free warranty for all new Eleveight products. Simply register your new product on our website within 30 days of purchasing and receive an extended warranty of 8 months beyond the legal warranty period of your country!

eleveightkites.com/product-registration-form



USER MANUAL

eleveightkites.com/user-manual

E/8 TRUSTED QUALITY

eleveightkites.com/e8-trusted-quality

Eleveight gear is built with innovative and quality workmanship. Details are strategically designed for long lasting durability, while keeping the gear light and agile.



**TRUSTED
QUALITY**

PLUS 8 EXTENDED WARRANTY

eleveightkites.com/product-registration-form

Eleveight stands behind all of its products! We offer an extended free warranty for all new Eleveight products. Simply register your new product on our website within 30 days of purchasing and receive an extended warranty of 8 months beyond the legal warranty period of your country!



**EXTENDED
WARRANTY**

THE BRAND

R&D



PRODUCT
MANAGEMENT
Peter Stiewe



BOARD
DESIGNER
Franz Schitzhofer



PRODUCT
DESIGN ENGINEER
Sören de Jong

SALES



GLOBAL SALES
DIRECTOR
Philippe Martin



EXPORT &
SALES MANAGER
Priscilla Metaireau



AREA MANAGER
ITALY
Alessio Alferoni



AREA MANAGER
ITALY
Filippo Costanzo



AREA MANAGER
SPAIN / PORTUGAL
Nico Pelaez Lindenn



AREA MANAGER
NORTH AMERICA
Kevin Wade



AREA MANAGER
BENELUX
Netherlands
Bart de Lozanne



AREA MANAGER
DACH
Philipp Mohr

MARKETING



GLOBAL MARKETING
DIRECTOR
Robert Bratz



GRAPHIC DESIGNER
ART DIRECTOR
Samuel Flotat



CONTENT
MANAGER
David Tonijuan Colomer



SOCIAL MEDIA
MANAGER
Niclas Malucha



VIDEO MAKER
Jeremy Hobart

OPERATION



OPERATIONS
MANAGER
José Alves



ELEVEIGHTKITES.COM